

## ABS DWV FITTINGS

### UW ADF0920

Effective September 1, 2020  
(Supersedes UW ADF0820)

The issuance of this price list is not an offer to sell the goods listed herein at the prices stated.

#### COUPLING STYLE NO. A100 H x H



Size	Item No.	Master Qty	Skid Qty	List
1 1/4	02932	100	4,500	11.16
1 1/2	02933	100	5,600	5.81
2	02934	100	4,900	7.28
3	02935	60	1,080	21.86
4	02936	25	700	36.48
6	03143	15	180	152.82

#### FEMALE ADAPTER STYLE NO. A101 H x FPT



Size	Item No.	Master Qty	Skid Qty	List
1 1/2	02866	100	5,600	9.98
2	02867	100	4,900	15.70
3	02869	30	1,470	42.02
4	03396	10	560	48.30
6	03147	10	180	183.67

#### PIPE INCREASER / REDUCER STYLE NO. A102 H x H



Size	Item No.	Master Qty	Skid Qty	List
2 x 1 1/2	02948	25	3,600	15.52
3 x 1 1/2	02949	25	1,400	46.00
3 x 2	02950	20	1,600	36.86
4 x 2	02951	10	800	76.76
4 x 3	02952	20	1,120	68.79

#### TRAP ADAPTER, MALE, W/ 1 PIECE POLY NUT STYLE NO. A103P SP x SJ



Size	Item No.	Master Qty	Skid Qty	List
1 1/2	03393	50	5,600	14.30
1 1/2 x 1 1/4	03379	75	6,000	19.73

#### TRAP ADAPTER, MALE, W/ PLASTIC NUT & 1 1/2 X 1 1/4 WASHER STYLE NO. A103R SP x SJ



Size	Item No.	Master Qty	Skid Qty	List
1 1/2 x 1 1/4	03389	50	5,600	16.03
1 1/2	03389	50	5,600	16.03

#### TRAP ADAPTER, MALE, W/ PLASTIC NUT & WASHER STYLE NO. A103W SP x SJ



Size	Item No.	Master Qty	Skid Qty	List
1 1/2	03410	50	5,600	16.82
1 1/2 x 1 1/4	03409	75	6,000	21.34

#### TRAP ADAPTER, MALE, W/ CHROME NUT & WASHER STYLE NO. A103X SP x SJ



Size	Item No.	Master Qty	Skid Qty	List
1 1/2 x 1 1/4	03378	100	8,000	22.78

#### TRAP ADAPTER, FEMALE, W/ 1 PIECE POLY NUT STYLE NO. A104P H x SJ



Size	Item No.	Master Qty	Skid Qty	List
1 1/2	03377	50	5,600	15.03
1 1/2 x 1 1/4	03395	50	5,600	17.58

#### TRAP ADAPTER, FEMALE, W/ PLASTIC NUT & WASHER STYLE NO. A104W H x SJ



Size	Item No.	Master Qty	Skid Qty	List
1 1/2	03383	50	5,600	15.13
2	03382	25	3,600	20.79
1 1/2 x 1 1/4	03384	50	5,600	19.81

#### TRAP ADAPTER, FEMALE, W/ CHROME NUT & WASHER STYLE NO. A104X H x SJ

Size	Item No.	Master Qty	Skid Qty	List
1 1/2	03376	50	5,600	25.72

#### FITTING CLEANOUT ADAPTER STYLE NO. A105 SP x FPT



Size	Item No.	Master Qty	Skid Qty	List
1 1/2	02922	50	7,200	12.24
2	02923	50	4,000	16.93
3	02924	25	1,225	42.73
4	02925	10	560	80.08

#### FITTING CLEANOUT ADAPTER W/ CO PLUG STYLE NO. A105X SP x FPT



Size	Item No.	Master Qty	Skid Qty	List
1 1/2	03001	50	5,600	20.51
2	03002	50	2,800	25.97
3	03003	25	875	57.41
4	03004	10	560	105.52

#### CLEANOUT PLUG STYLE NO. A106 MPT



Size	Item No.	Master Qty	Skid Qty	List
1 1/2	02938	50	7,200	8.26
2	02939	50	7,200	9.03
2 1/2	02940	25	3,600	27.60
3	02941	25	3,600	14.69
3 1/2	02943	30	3,360	59.84
4	02942	30	2,400	25.44
6	03146	10	800	86.07

#### FLUSH BUSHING STYLE NO. A107 SP x H STYLE #3



Size	Item No.	Master Qty	Skid Qty	List
1 1/2 x 1 1/4	02904	100	14,400	33.44
2 x 1 1/4	02905	50	7,200	15.47
2 x 1 1/2	02906	50	7,200	8.87
3 x 1 1/2	02907	30	2,400	38.78
3 x 2	02908	30	2,400	24.26
4 x 2	02910	30	1,470	72.06
4 x 3	02909	30	1,470	38.18

#### FLANGE BUSHING W/ TUBE STOP STYLE NO. A107S SP x H STYLE #1



Size	Item No.	Master Qty	Skid Qty	List
6 x 4	03144	10	490	202.39

#### FLUSH BUSHING STYLE NO. A108 S x FPT STYLE #3



Size	Item No.	Master Qty	Skid Qty	List
2 x 1 1/2	02913	50	7,200	29.00

#### MALE ADAPTER STYLE NO. A109 H x MPT



Size	Item No.	Master Qty	Skid Qty	List
1 1/2	02927	50	7,200	8.47
2	02928	50	5,600	14.81
3	02929	25	1,400	39.72
4	02930	25	875	80.61

#### C/O PLUG, FLUSH STYLE NO. A110 H x MPT



Size	Item No.	Master Qty	Skid Qty	List
2	03017	25	7,200	42.90
3	03038	50	7,200	48.98
4	03015	25	3,600	52.27

#### MALE FITTINGS ADAPTER STYLE NO. A111 SP x MPT



Size	Item No.	Master Qty	Skid Qty	List
1 1/2	03386	50	7,200	24.43
2	03385	25	3,600	50.44

#### TRAY PLUG ADAPTER, SPIGOT STYLE NO. A113S SP x NPSM



Size	Item No.	Master Qty	Skid Qty	List
1 1/2	03419	50	2,450	22.62

#### CAP THREADED STYLE NO. A114 FPT



Size	Item No.	Master Qty	Skid Qty	List
1 1/2	02993	15	5,400	16.86

#### CAP SOCKET STYLE NO. A116 H



Size	Item No.	Master Qty	Skid Qty	List
1 1/2	02977	10	2,880	19.29
2	02978	5	1,800	26.67
3	02979	10	1,440	55.13
4	02980	5	560	53.93
6	03057	3	105	120.38

#### ADAPTER COUPLING STYLE NO. A117 S/D H x DWV H ADAPTS SEWER & DRAIN PIPE TO DWV PIPE



Size	Item No.	Master Qty	Skid Qty	List
4	02963	20	1,120	94.52
4 x 3	02962	20	1,120	54.04

#### ADAPTER BUSHING STYLE NO. A118 DWV SP x SD H (Adapts DWV Hub to S/D Spigot)



Size	Item No.	Master Qty	Skid Qty	List
3	02990	25	2,800	33.86
4	02991	10	1,440	39.57

#### NO HUB ADAPTER STYLE NO. A119 NO H x H (Adapts CI NO HUB TO DWV PIPE)



Size	Item No.	Master Qty	Skid Qty	List
2	02954	25	3,600	29.56
3	02955	20	1,600	54.99
4	02956	15	840	79.70

#### HUB ADAPTER, CAST IRON STYLE NO. A123 SP X H (ADAPTS CI HUB TO DWV PIPE)



Size	Item No.	Master Qty	Skid Qty	List
2 x 2	02957	20	1,600	95.14
4 x 4	02959	20	360	140.24

#### REPAIR COUPLING STYLE NO. A130 H x H



Size	Item No.	Master Qty	Skid Qty	List
1 1/2	02965	25	3,600	38.48
2	02966	25	3,600	20.51
3	02967	10	1,120	50.93
4	02968	5	560	97.93

#### SLIP JOINT NUT STYLE NO. A140 NPSM Thread



Size	Item No.	Master Qty	Skid Qty	List
1 1/2	02744	100	11,200	5.80

#### SLIP JOINT WASHER STYLE NO. A141 (FOR USE WITH 1 1/4 SJ NUT)



Size	Item No.	Master Qty	Skid Qty	List
1 1/2	02747	600	10,800	2.22

# ABS DWV FITTINGS

## 1/4 BEND

### STYLE NO. A300

H x H



Size	Item No.	Master Qty	Skid Qty	List
1 1/2	02876	100	2,800	11.29
2	02877	50	1,400	17.39
3	02878	25	450	43.80
4	02879	10	180	89.78
6	03130	5	60	382.83

## 1/4 BEND, REDUCING

### STYLE NO. A300R

H x H



Size	Item No.	Master Qty	Skid Qty	List
2 x 1 1/2	03092	10	1,440	74.78

## 1/4 BEND, W/ SIDE INLET

### STYLE NO. A300S

H x H



Size	Item No.	Master Qty	Skid Qty	List
3 x 3 x 2	03070	10	350	124.41

## 1/4 BEND, STREET

### STYLE NO. A302

SP x H



Size	Item No.	Master Qty	Skid Qty	List
1 1/2	02880	100	3,500	14.54
2	02881	50	1,750	24.30
3	02882	20	560	53.39
4	02883	10	180	106.76

## 1/4 BEND, W/ LOW HEEL INLET

### STYLE NO. A303

H x H



Size	Item No.	Master Qty	Skid Qty	List
3 x 3 x 2	03042	25	400	73.57
4 x 4 x 2	03043	15	180	215.59

## LONG SWEEP, 1/4 BEND

### STYLE NO. A304

H x H



Size	Item No.	Master Qty	Skid Qty	List
1 1/2	02871	50	1,750	19.57
2	02872	25	1,225	24.34
3	02873	10	350	59.53
4	02874	5	175	101.63

## LONG SWEEP, 1/4 BEND W/ LOW HEEL INLET

### STYLE NO. A307

H x H



Size	Item No.	Master Qty	Skid Qty	List
3 x 3 x 1 1/2	03025	25	300	142.68
3 x 3 x 2	03024	25	300	116.54

## LONG SWEEP, 1/4 BEND, STREET

### STYLE NO. A309

SP x H



Size	Item No.	Master Qty	Skid Qty	List
1 1/2	03060	50	2,450	25.38
2	03061	25	1,225	30.66
3	03063	20	360	107.48

## 1/4 BEND, STREET W/ LOW HEEL INLET

### STYLE NO. A310

H x H x SP



Size	Item No.	Master Qty	Skid Qty	List
3 x 3 x 2	03026	15	420	105.61

## 1/6 BEND

### STYLE NO. A319

H x H



Size	Item No.	Master Qty	Skid Qty	List
1 1/2	02895	40	3,200	19.90
2	02896	25	1,400	28.24
3	02897	20	560	90.69
4	02982	10	280	136.89

## 1/6 BEND, STREET

### STYLE NO. A320

SP x H



Size	Item No.	Master Qty	Skid Qty	List
1 1/2	03020	40	3,200	62.51
2	03021	25	2,000	61.86
3	03022	20	700	177.10

## 1/8 BEND

### STYLE NO. A321

H x H



Size	Item No.	Master Qty	Skid Qty	List
1 1/2	02885	100	3,500	10.31
2	02886	50	1,750	15.98
3	02887	20	560	38.29
4	02888	10	280	71.96
6	03132	3	84	320.41

## 1/8 BEND, STREET

### STYLE NO. A323

SP x H



Size	Item No.	Master Qty	Skid Qty	List
1 1/2	02890	100	3,500	12.89
2	02891	50	1,750	17.10
3	02892	20	700	42.21
4	02893	10	280	73.16
6	03133	3	84	401.69

## 1/16 BEND

### STYLE NO. A324

H x H



Size	Item No.	Master Qty	Skid Qty	List
1 1/2	02899	50	4,000	15.06
2	02900	25	2,000	17.17
3	02901	20	700	44.14
4	02983	15	420	67.20
6	02988	3	84	801.09

## 1/16 BEND, STREET

### STYLE NO. A326

SP x H



Size	Item No.	Master Qty	Skid Qty	List
1 1/2	02984	50	4,000	42.89
2	02985	25	2,800	38.79
3	02986	20	700	65.80
4	02987	10	490	114.82

## DOUBLE 1/4 BEND

### STYLE NO. A327

H x H



Size	Item No.	Master Qty	Skid Qty	List
1 1/2	03045	20	1,600	52.73
2	03046	25	875	67.60
3	03047	10	280	249.60
2 x 1 1/2 x 1 1/2	03049	25	1,400	73.78

## CLOSET BEND, REDUCING

### STYLE NO. A329

H x H



Size	Item No.	Master Qty	Skid Qty	List
3 x 4	03093	10	280	67.58

## CLOSET BEND, REDUCING

### STYLE NO. A330

H x S



Size	Item No.	Master Qty	Skid Qty	List
3 x 4	03107	10	280	118.49

## CLOSET BEND, REDUCING, W/ TEST CAP

### STYLE NO. A330X

H x S



Size	Item No.	Master Qty	Skid Qty	List
3 x 4	03108	10	280	128.18

## VENT ELBOW

### STYLE NO. A331

H x H



Size	Item No.	Master Qty	Skid Qty	List
1 1/2	03084	20	2,880	20.23
2	03085	30	1,680	33.47
3	03086	25	700	82.97

## VENT ELBOW, STREET

### STYLE NO. A333

H x SP



Size	Item No.	Master Qty	Skid Qty	List
1 1/2	03088	25	2,800	19.77
2	03089	20	2,240	31.19

## SANITARY TEE

### STYLE NO. A400

ALL HUB



Size	Item No.	Master Qty	Skid Qty	List
1 1/2	02752	100	1,800	16.70
2	02753	35	980	25.73
3	02754	30	360	69.90
4	02755	5	140	124.27
6	02756	6	72	619.98

## SANITARY TEE, REDUCING

### STYLE NO. A401

ALL HUB



Size	Item No.	Master Qty	Skid Qty	List
2 x 1 1/2 x 1 1/2	02761	25	1,225	22.91
2 x 1 1/2 x 2	02760	25	875	25.74
2 x 2 x 1 1/2	02758	50	900	22.39
3 x 3 x 1 1/2	02764	20	560	48.12
3 x 3 x 2	02763	10	490	55.67
4 x 4 x 2	02765	10	280	133.49
4 x 4 x 3	02766	10	180	133.64
6 x 6 x 4	02768	6	72	702.21

## SANITARY TEE, STREET

### STYLE NO. A403

SP x H x H



Size	Item No.	Master Qty	Skid Qty	List
1 1/2	03112	20	1,600	41.48
2	03113	25	875	56.10
3	03114	30	360	96.14
4	03120	10	160	292.70

## SANITARY TEE, STREET, REDUCING

### STYLE NO. A404

SP x H x H



Size	Item No.	Master Qty	Skid Qty	List
2 x 1 1/2 x 1 1/2	03115	25	1,225	41.66
2 x 1 1/2 x 2	03116	25	875	69.06
2 x 2 x 1 1/2	03117	50	1,400	44.83
3 x 3 x 1 1/2	03118	10	490	137.61
3 x 3 x 2	03119	20	560	114.92

## SANITARY TEE W/ LEFT SIDE INLET

### STYLE NO. A416

SP x H x H



Size	Item No.	Master Qty	Skid Qty	List
3 x 3 x 3 x 1 1/2	02781	10	280	161.31
3 x 3 x 3 x 2	02782	10	280	158.97

## SANITARY TEE W/ RIGHT SIDE INLET

### STYLE NO. A417

ALL HUB



Size
------

# ABS DWV FITTINGS

## VENT TEE STYLE NO. A441 ALL HUB



Size	Item No.	Master Qty	Skid Qty	List
1 1/2	03403	25	2,000	50.71
2	03404	25	1,225	42.06
3	03405	10	490	140.10

## CLEANOUT TEE WITH PLUG STYLE NO. A444X H x H x FPT



Size	Item No.	Master Qty	Skid Qty	List
1 1/2	02997	10	1,440	48.10
2	02998	10	1,120	52.61
3	02999	10	490	96.21
4	03000	5	175	203.17

## FLUSH CLEANOUT TEE STYLE NO. A445 H x H x FPT



Size	Item No.	Master Qty	Skid Qty	List
1 1/2	03413	20	2,240	39.74
2	03414	20	980	43.58
3	03415	10	490	81.52
4	03416	10	180	177.72

## TWO-WAY CLEANOUT STYLE NO. A448 ALL HUB



Size	Item No.	Master Qty	Skid Qty	List
3	02237	10	180	145.37
4	02238	5	90	229.89

## DOUBLE FIXTURE FITTING STYLE NO. A500 ALL HUB



Size	Item No.	Master Qty	Skid Qty	List
2	02246	20	560	96.58
3	02249	10	160	223.33
2 x 1 1/2 x 1 1/2 x 1 1/2	02247	20	700	65.66
2 x 1 1/2 x 2 x 2	02248	20	560	101.31
2 x 2 x 1 1/2 x 1 1/2	02244	20	700	74.58
3 x 2 x 3 x 3	02250	10	160	267.49

## COMBINATION WYE & 1/8 BEND - ONE PIECE STYLE NO. A501 ALL HUB



Size	Item No.	Master Qty	Skid Qty	List
1 1/2	02853	50	900	43.33
2	02858	20	560	44.14
3	02852	10	180	104.77
4	02860	10	120	219.06

## COMBINATION WYE & 1/8 BEND, REDUCING - ONE PIECE STYLE NO. A502 ALL HUB



Size	Item No.	Master Qty	Skid Qty	List
2 x 1 1/2 x 1 1/2	02835	5	720	67.09
2 x 2 x 1 1/2	02865	20	980	47.17
3 x 3 x 1 1/2	02837	15	420	118.49
3 x 3 x 2	02857	10	350	68.08
4 x 4 x 2	02863	5	175	122.63
4 x 4 x 3	02864	5	140	157.32

## WYE STYLE NO. A600 ALL HUB



Size	Item No.	Master Qty	Skid Qty	List
1 1/2	02822	50	1,400	29.55
2	02823	25	875	36.12
3	02824	25	300	77.69
4	02825	5	140	158.00
6	03135	4	48	475.41

## WYE, REDUCING STYLE NO. A601 ALL HUB



Size	Item No.	Master Qty	Skid Qty	List
2 x 1 1/2 x 1 1/2	02831	25	1,225	48.33
2 x 1 1/2 x 2	02832	10	800	88.98
2 x 2 x 1 1/2	02826	25	1,225	41.02
3 x 3 x 1 1/2	02827	15	525	73.16
3 x 3 x 2	02828	25	400	54.56
4 x 4 x 1 1/2	02833	5	175	251.70
4 x 4 x 2	02829	10	180	100.83
4 x 4 x 3	02830	10	160	136.38
6 x 6 x 4	03137	5	60	430.04

## WYE, STREET STYLE NO. A602 SP x H x H



Size	Item No.	Master Qty	Skid Qty	List
1 1/2	03367	50	1,800	24.31
2	03368	30	840	62.79
3	03369	10	280	154.88
4	03370	5	140	209.53

## WYE, STREET, REDUCING STYLE NO. A603 SP x H x H



Size	Item No.	Master Qty	Skid Qty	List
3 x 3 x 2	03373	30	480	135.99
4 x 4 x 3	03375	10	160	242.46

## DOUBLE WYE STYLE NO. A611 ALL HUB



Size	Item No.	Master Qty	Skid Qty	List
1 1/2	02838	40	1,120	84.94
2	02839	20	560	101.38
3	02840	15	180	227.87
4	02841	5	80	446.16

## DOUBLE WYE, REDUCING STYLE NO. A612 ALL HUB



Size	Item No.	Master Qty	Skid Qty	List
2 x 2 x 1 1/2 x 1 1/2	02847	10	560	96.79
3 x 3 x 2 x 2	02844	10	280	158.67
4 x 4 x 3 x 3	02846	5	90	369.34

## RETURN BEND STYLE NO. A700 H X H



Size	Item No.	Master Qty	Skid Qty	List
1 1/2	03466	20	1,600	35.91
2	03467	35	630	40.02
3	03468	10	280	293.18
4	03469	5	140	529.67

## TAIL PIECE ADAPTER W/ 2 SIZE SJ WASHERS STYLE NO. A704P H X H



Size	Item No.	Master Qty	Skid Qty	List
1 1/2 x 1 1/4	02975	25	3,600	40.14
1 1/2	02975	25	3,600	40.14

## P-TRAP W/ SOLVENT WELD JOINT STYLE NO. A706X H X H



Size	Item No.	Master Qty	Skid Qty	List
1 1/2	02214	25	1,225	38.87
2	02222	20	560	47.19
3	02230	10	180	202.58
4	02231	4	72	371.56

## P-TRAP W/ SOLVENT WELD JOINT & CLEAN OUT STYLE NO. A707X H X H



Size	Item No.	Master Qty	Skid Qty	List
1 1/2	02223	10	1,120	58.66
2	02224	10	560	167.69

## P-TRAP W/ UNION STYLE NO. A708P H X H



Size	Item No.	Master Qty	Skid Qty	List
1 1/2	02215	25	875	52.27
2	02216	20	560	95.60

## LA P-TRAP W/ UNION & 1 PC POLY NUT STYLE NO. A711M SJ x H



Size	Item No.	Master Qty	Skid Qty	List
1 1/2	02221	25	700	83.18

## LA P-TRAP W/ UNION & 2 SIZE SJ WASHERS STYLE NO. A711P SJ x H (FURNISHED W/BOTH SIZE SJ WASHERS)



Size	Item No.	Master Qty	Skid Qty	List
1 1/4 x 1 1/2	02220	25	700	100.24
1 1/2	02220	25	700	100.24

## DRUM TRAP, W/ CLEANOUT STYLE NO. A720X H x H (W/PLUG)



Size	Item No.	Master Qty	Skid Qty	List
3 x 6 x 1 1/2	03100	15	420	146.47

## CLOSET FLANGE STYLE NO. A800 H (ONE PIECE WITH SLOTS)

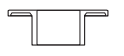

Size	Item No.	Master Qty	Skid Qty	List
4 x 4	02902	25	700	44.28

## CLOSET FLANGE W/ STOP - HUB STYLE NO. A800S H (ONE PIECE WITH SLOTS)

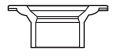

Size	Item No.	Master Qty	Skid Qty	List
4 x 3	02903	25	700	44.57

## CLOSET FLANGE - HUB W/ KNOCK OUT STYLE NO. A800KO H (ONE PIECE WITH SLOTS)

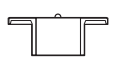

Size	Item No.	Master Qty	Skid Qty	List
4 x 3	02254	25	700	55.24

## CLOSET FLANGE, SPIGOT, REDUCING STYLE NO. A801 SP (ONE PIECE PLASTIC)



Size	Item No.	Master Qty	Skid Qty	List
4 x 3	02919	25	875	60.98

## CLOSET FLANGE - MALE STYLE NO. A808 MPT



Size	Item No.	Master Qty	Skid Qty	List
4 x 3	02260	25	700	45.35

## CLOSET FLANGE - HUB, ADJUSTABLE PLASTIC RING STYLE NO. A810 H (W / SLOTS)



Size	Item No.	Master Qty	Skid Qty	List
4 x 4	02256	25	700	142.98

## CLOSET FLANGE, W/ STOP, ADJUSTABLE, W/ PLASTIC RING STYLE NO. A810S H (W / SLOTS)



Size	Item No.	Master Qty	Skid Qty	List
4 x 3	02251	25	700	140.24

## CLOSET FLANGE, ADJUSTABLE, W/ METAL RING, EPOXY COATED STYLE NO. A811 H (W / SLOTS)



Size	Item No.	Master Qty	Skid Qty	List
4 x 3	02227	25	700	106.97
4 x 4	02226	25	700	97.44

## CLOSET FLANGE, SPIGOT, ADJUSTABLE, W/ METAL RING, EPOXY COATED STYLE NO. A812 SP



Size	Item No.	Master Qty	Skid Qty	List
4 x 3	02228	25	875	116.74
4 x 4	02229	25	700	126.21

## CLOSET FLANGE, SPIGOT, ADJUSTABLE, W/ PLASTIC RING STYLE NO. A812P SP



Size	Item No.	Master Qty	Skid Qty	List
4 x 3	02252	25	875	169.39

## FLUSH CLOSET FLANGE STYLE NO. A815 H (FITS OVER 3" OR INSIDE 4" SCH 40 DWV PIPE)



Size	Item No.	Master Qty	Skid Qty	List
4 x 4 / 4 x 3	02255	25	875	123.66

## OFFSET CLOSET FLANGE, ADJUSTABLE, W/ METAL RING, EPOXY COATED STYLE NO. A820 H



Size	Item No.	Master Qty	Skid Qty	List
4 x 3	02920	15	525	149.70

## ABS DWV FITTINGS

### OFFSET CLOSET FLANGE - HUB, ADJ PLASTIC RING STYLE NO. A820P

Size	Item No.	Master Qty	Skid Qty	List
4 x 3	03040	15	525	241.30

### CLOSET FLANGE - SPIGOT, ADJ METAL RING, EXTND 4" SPIGOT STYLE NO. A824

Size	Item No.	Master Qty	Skid Qty	List
4	02210	20	360	200.45

### SWIVEL TRAY PLUG ADAPTER W/ WASHER STYLE NO. A900

Size	Item No.	Master Qty	Skid Qty	List
1 1/2	03418	30	4,320	38.38

### EXTENDED SWIVEL TRAY PLUG ADAPTER W/ WASHER STYLE NO. A900X



SP X NPSM Thread (EXTENDED)

Size	Item No.	Master Qty	Skid Qty	List
1 1/2	03013	10	2,880	49.24

### SWIVEL TRAY PLUG ADAPTER W/ WASHER STYLE NO. A910



H X NPSM Thread

Size	Item No.	Master Qty	Skid Qty	List
1 1/2	03421	30	4,320	43.34