

PVC DWV FITTINGS

UW PDF0326

Effective March 26, 2026
(Supersedes UW PDF0126)

The issuance of this price list is not an offer to sell the goods listed herein at the prices stated.

COUPLING STYLE NO. P100 H x H



Diameter	Item No.	Master Qty	Skid Qty	List
1 1/4	05932	100	8,000	75.05
1 1/2	05933	100	5,600	15.70
2	05934	100	4,900	21.50
3	05935	60	1,080	75.05
4	05936	25	700	127.55
6	06143	15	180	417.05
8	06145	6	72	693.05

FEMALE ADAPTER STYLE NO. P101 FPT x H



Diameter	Item No.	Master Qty	Skid Qty	List
1 1/4	05868	100	8,000	166.10
1 1/2	05866	100	5,600	29.75
2	05867	100	4,900	50.65
3	05869	25	1,470	135.10
4	06396	10	560	175.50
6	06147	10	180	562.80

PIPE INCREASER / REDUCER STYLE NO. P102 H x H



Diameter	Item No.	Master Qty	Skid Qty	List
1 1/2 x 2	05948	25	3,600	47.65
1 1/2 x 3	05949	25	1,400	139.55
2 x 3	05950	20	1,600	108.75
2 x 4	05951	10	800	213.05
3 x 4	05952	20	1,120	227.80
4 x 6	05981	5	140	885.80

TRAP ADAPTER, MALE, W / 1 PIECE POLY NUT STYLE NO. P103P SP x SJ



Diameter	Item No.	Master Qty	Skid Qty	List
1 1/2 x 1 1/4	06379	75	6,000	61.50
1 1/2	06393	50	5,600	66.75

TRAP ADAPTER, MALE, W / PLASTIC NUT & 1 1/2 X 1 1/4 WASHER STYLE NO. P103R SP x SJ



Diameter	Item No.	Master Qty	Skid Qty	List
1 1/2 x 1 1/4	06389	50	5,600	65.70

TRAP ADAPTER, MALE, W / PLASTIC NUT AND WASHER STYLE NO. P103W SP x SJ



Diameter	Item No.	Master Qty	Skid Qty	List
1 1/2	06410	50	5,600	63.35
2	06390	25	3,600	333.95
1 1/2 x 1 1/4	06409	75	6,000	79.75

TRAP ADAPTER, MALE, W / CHROME NUT & WASHER STYLE NO. P103X SP x SJ



Diameter	Item No.	Master Qty	Skid Qty	List
1 1/2 x 1 1/4	06378	100	8,000	82.45
1 1/2	06392	50	5,600	83.40

TRAP ADAPTER, FEMALE, W / 1 PIECE POLY NUT STYLE NO. P104P H x SJ



Diameter	Item No.	Master Qty	Skid Qty	List
1 1/4	06381	50	5,600	71.85
1 1/2 x 1 1/4	06395	50	5,600	58.50
1 1/2	06377	50	5,600	58.90

TRAP ADAPTER, FEMALE W/ P-NUT & WASHER STYLE NO. P104R

Diameter	Item No.	Master Qty	Skid Qty	List
1 1/2	06399	50	5,600	67.10

TRAP ADAPTER, FEMALE, W/ PLASTIC NUT AND WASHER STYLE NO. P104W H x SJ



Diameter	Item No.	Master Qty	Skid Qty	List
1 1/4	06380	50	5,600	63.80
1 1/2 x 1 1/4	06384	50	5,600	61.90
1 1/2	06383	50	5,600	121.75
2	06382	25	3,600	61.20

TRAP ADAPTER, FEMALE, W / CHROME NUT & WASHER STYLE NO. P104X H x SJ



Diameter	Item No.	Master Qty	Skid Qty	List
1 1/2	06376	50	5,600	82.75
1 1/2 x 1 1/4	06394	50	5,600	80.20

FITTING CLEANOUT ADAPTER STYLE NO. P105 SP x FPT



Diameter	Item No.	Master Qty	Skid Qty	List
1 1/2	05922	50	7,200	37.85
2	05923	50	4,000	50.65
3	05924	25	1,225	135.90
4	05925	10	560	223.45
6	06148	10	280	636.05

SWIVEL FITTING CLEANOUT ADAPTER STYLE NO. P105SW

Diameter	Item No.	Master Qty	Skid Qty	List
1 1/2	06418	30	4,320	137.05

FITTING CLEANOUT ADAPTER, W / CLEANOUT PLUG STYLE NO. P105X SP x FPT



Diameter	Item No.	Master Qty	Skid Qty	List
1 1/2	06001	50	5,600	65.95
2	06002	50	2,800	82.25
3	06003	25	875	192.05
4	06004	10	560	306.60
6	06005	10	180	900.35

CLEANOUT PLUG STYLE NO. P106 MPT



Diameter	Item No.	Master Qty	Skid Qty	List
1 1/2	05938	50	7,200	28.10
2	05939	50	7,200	31.60
3	05941	25	3,600	56.15
4	05942	20	2,400	83.20
6	06146	10	800	264.25

FLUSH BUSHING STYLE NO. P107 SP x H STYLE #3



Diameter	Item No.	Master Qty	Skid Qty	List
1 1/2 x 1 1/4	05904	100	14,400	62.65
2 x 1 1/4	05905	50	7,200	74.90
2 x 1 1/2	05906	50	7,200	27.40
3 x 1 1/2	05907	30	2,400	130.75
3 x 2	05908	30	2,400	69.05
4 x 2	05910	30	1,470	227.30
4 x 3	05909	30	1,470	117.50

FLANGE BUSHING, W / TUBE STOP STYLE NO. P107S SP x H STYLE #1



Diameter	Item No.	Master Qty	Skid Qty	List
6 x 4	06144	10	490	584.05
8 x 6	06149	1	144	1,143.35

FLUSH BUSHING STYLE NO. P108 SP x FPT STYLE #1



Diameter	Item No.	Master Qty	Skid Qty	List
2 x 1 1/2	05913	50	7,200	168.60

MALE ADAPTER STYLE NO. P109 H x MPT



Diameter	Item No.	Master Qty	Skid Qty	List
1 1/4	05931	50	7,200	93.75
1 1/4 x 1 1/2	05926	25	3,600	29.85
1 1/2	05927	50	5,600	40.00
2	05928	50	5,600	111.85
3	05929	25	1,400	253.25
4	05930	25	875	43.10

FLUSH CLEANOUT PLUG STYLE NO. P110 MPT

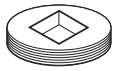

Diameter	Item No.	Master Qty	Skid Qty	List
2	06017	25	7,200	138.60
3	06018	50	7,200	101.90
4	06015	25	3,600	118.55

MALE FITTING ADAPTER STYLE NO. P111 SP x MPT



Diameter	Item No.	Master Qty	Skid Qty	List
1 1/2	06386	50	7,200	128.90
1 1/2 x 1 1/4	06387	100	8,000	143.80
2	06385	25	3,600	263.30
3	06366	25	1,225	117.85

TRAY PLUG ADAPTER STYLE NO. P113 H x NPSM THREAD



Diameter	Item No.	Master Qty	Skid Qty	List
1 1/2	06014	10	2,160	86.70

CAP SOCKET STYLE NO. P116 H



Diameter	Item No.	Master Qty	Skid Qty	List
1 1/2	05977	10	2,880	63.25
2	05978	5	1,800	105.45
3	05979	10	1,440	176.35
4	05980	5	560	251.50
6	06057	5	175	635.35
8	06058	3	63	1,708.00

ADAPTER COUPLING STYLE NO. P117 S/D H x DWV HUB (ADAPTS SEWER & DRAIN PIPE TO DWV PIPE)



Diameter	Item No.	Master Qty	Skid Qty	List
3	05970	10	800	426.35
4	05963	10	560	247.15
4 x 3	05962	20	1,120	238.15

ADAPTER COUPLING STYLE NO. P117X S/D X DWV HUB (Adapts 4" S/D HUB TO 3" DWV Spigot PIPE)



Diameter	Item No.	Master Qty	Skid Qty	List
4 x 3	05992	20	700	270.80

PVC DWV FITTINGS

ADAPTER BUSHING

STYLE NO. P118
DWV SP x SD H
(Adapts DWV Hub to S/D Spigot)



Diameter	Item No.	Master Qty	Skid Qty	List
3	05990	25	2,800	215.60
4	05991	10	1,440	94.15

NO HUB ADAPTER

STYLE NO. P119
NO H x H (Adapts CI NO HUB TO DWV PIPE)



Diameter	Item No.	Master Qty	Skid Qty	List
1 1/2	05802	25	3,600	206.30
2	05954	25	3,600	82.45
3	05955	20	1,600	119.90
4	05956	15	840	153.70
4 x 3	05953	10	1,120	295.60

SPIGOT ADAPTER, CAST IRON

STYLE NO. P122
ALL HUB (ADAPTS CI SPIGOT TO DWV PIPE)



Diameter	Item No.	Master Qty	Skid Qty	List
2	05944	10	1,440	308.35
4	05946	15	420	461.95

HUB ADAPTER, CAST IRON

STYLE NO. P123
SP x H (ADAPTS CI HUB TO DWV PIPE)



Diameter	Item No.	Master Qty	Skid Qty	List
2	05957	20	1,600	156.30
3	05958	20	700	296.45
4	05959	20	360	445.90

HUB ADAPTER, CAST IRON, INCREASER

STYLE NO. P123R
SP x H (ADAPTS CI HUB TO DWV PIPE)

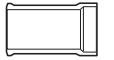

Diameter	Item No.	Master Qty	Skid Qty	List
2 X 1 1/2 X 2	05961	10	1,440	296.65
4 X 3	05960	10	490	338.00

REPAIR COUPLING

STYLE NO. P130
H x H



Diameter	Item No.	Master Qty	Skid Qty	List
1 1/2	05965	25	3,600	86.20
2	05966	25	3,600	60.05
3	05967	10	1,120	151.95
4	05968	5	560	292.20
6	05969	5	175	1,306.45

TEST CAP

STYLE NO. P131

Diameter	Item No.	Master Qty	Skid Qty	List
1 1/2	05411	100	54,000	35.25
2	05412	100	28,800	37.20
3	05413	50	10,800	38.45
4	05414	50	9,600	48.15

SLIP JOINT NUT

STYLE NO. P140



Diameter	Item No.	Master Qty	Skid Qty	List
1 1/2	05744	100	11,200	12.85
2	05741	100	8,000	21.31

1/4 BEND

STYLE NO. P300
H x H



Diameter	Item No.	Master Qty	Skid Qty	List
1 1/4	05875	100	3,500	116.20
1 1/2	05876	100	2,800	33.25
2	05877	50	1,400	52.60
3	05878	25	450	154.65
4	05879	10	180	305.30
6	06130	5	60	1,069.35
8	06131	1	28	1,381.70

1/4 BEND, REDUCING

STYLE NO. P300R
H x H



Diameter	Item No.	Master Qty	Skid Qty	List
2 x 1 1/2	06092	10	1,440	191.70

1/4 BEND, W / SIDE INLET

STYLE NO. P300S
H x H



Diameter	Item No.	Master Qty	Skid Qty	List
3 x 3 x 1 1/2	06069	10	490	449.20
3 x 3 x 2	06070	10	350	302.10

1/4 BEND, STREET

STYLE NO. P302
SP x H



Diameter	Item No.	Master Qty	Skid Qty	List
1 1/4	05894	35	3,920	189.70
1 1/2	05880	100	3,500	43.10
2	05881	50	1,750	66.25
3	05882	15	560	184.50
4	05883	10	180	308.60
6	05889	5	80	1,379.40

1/4 BEND, W / LOW HEEL INLET

STYLE NO. P303
H x H



Diameter	Item No.	Master Qty	Skid Qty	List
3 x 3 x 1 1/2	06041	25	400	332.40
3 x 3 x 2	06042	25	400	266.25
4 x 4 x 2	06043	15	180	525.80

LONG SWEEP 1/4 BEND

STYLE NO. P304
H x H



Diameter	Item No.	Master Qty	Skid Qty	List
1 1/2	05871	50	1,750	77.30
2	05872	20	1,225	86.35
3	05873	10	350	198.75
4	05874	5	175	375.10
6	06012	5	60	1,462.55

LONG SWEEP 1/4 BEND

STYLE NO. P305
W / HIGH HEEL INLET
H x H



Diameter	Item No.	Master Qty	Skid Qty	List
3 x 3 x 2	06027	25	300	1,453.70

LONG SWEEP 1/4 BEND

W / LOW HEEL INLET
STYLE NO. P307
H x H



Diameter	Item No.	Master Qty	Skid Qty	List
3 x 3 x 2	06024	25	300	596.30

LONG SWEEP 1/4 BEND, STREET

STYLE NO. P309
SP x H



Diameter	Item No.	Master Qty	Skid Qty	List
1 1/2	06060	50	2,450	118.55
2	06061	25	1,225	142.00
3	06063	20	360	353.40
4	06064	5	175	544.40

1/4 BEND W / LOW HEEL INLET

STYLE NO. P310
H x H x SP



Diameter	Item No.	Master Qty	Skid Qty	List
3 x 3 x 2	06026	15	420	761.75

LONG SWEEP 1/4 BEND W / SIDE INLET

STYLE NO. P311
H x H



Diameter	Item No.	Master Qty	Skid Qty	List
3 x 3 x 2	06050	25	300	885.25

1/6 BEND

STYLE NO. P319
H x H



Diameter	Item No.	Master Qty	Skid Qty	List
1 1/2	05895	40	3,200	77.75
2	05896	25	1,400	90.45
3	05897	20	560	333.75
4	05898	10	280	444.95

1/6 BEND, STREET

STYLE NO. P320
SP x H



Diameter	Item No.	Master Qty	Skid Qty	List
1 1/2	06020	40	3,200	141.00
2	06021	25	2,000	181.60
3	06022	20	700	391.65
4	06023	10	280	609.10

1/8 BEND

STYLE NO. P321
H x H



Diameter	Item No.	Master Qty	Skid Qty	List
1 1/4	05884	50	4,000	79.30
1 1/2	05885	100	3,500	32.65
2	05886	50	1,750	48.70
3	05887	20	560	138.60
4	05888	10	280	253.55
6	06132	3	84	937.15
8	06134	1	28	1,226.95

1/8 BEND, STREET

STYLE NO. P323
SP x H



Diameter	Item No.	Master Qty	Skid Qty	List
1 1/4	06016	40	4,480	108.55
1 1/2	05890	100	3,500	31.25
2	05891	50	1,750	49.80
3	05892	20	700	131.30
4	05893	10	280	225.00
6	06133	3	84	1,110.20
8	06136	1	28	1,331.60

1/16 BEND

STYLE NO. P324
H x H



Diameter	Item No.	Master Qty	Skid Qty	List
1 1/2	05899	50	4,000	46.40
2	05900	25	2,000	55.00
3	05901	20	700	135.50
4	05983	15	420	214.25
6	05988	3	84	1,237.20

1/16 BEND, STREET

STYLE NO. P326
SP x H



Diameter	Item No.	Master Qty	Skid Qty	List
1 1/2	05984	50	4,000	125.65
2	05985	25	2,800	134.70
3	05986	20	700	209.85
4	05987	15	490	304.60
6	06011	4	112	1,198.65

DOUBLE 1/4 BEND

STYLE NO. P327
H x H



Diameter	Item No.	Master Qty	Skid Qty	List
1 1/2	06045	20	1,600	131.30
2	06046	25	875	179.10
2 x 1 1/2 x 1 1/2	06049	25	1,400	468.10
3	06047	10	280	164.95

CLOSET BEND, REDUCING

STYLE NO. P329
H x H



Diameter	Item No.	Master Qty	Skid Qty	List
4 x 3	06093	10	280	248.70

CLOSET BEND, REDUCING

STYLE NO. P330
H x S



Diameter	Item No.	Master Qty	Skid Qty	List
4 x 3	06107	10	280	484.25

CLOSET BEND, REDUCING,

W / TEST CAP
STYLE NO. P330X
H x S



SANITARY TEE
STYLE NO. P400
ALL HUB



Diameter	Item No.	Master Qty	Skid Qty	List
1 1/4	05751	25	2,800	124.55
1 1/2	05752	100	1,800	58.30
2	05753	35	980	85.65
3	05754	30	360	225.45
4	05755	5	140	411.60
6	05756	6	72	1,652.60
8	05775	2	24	3,661.80

SANITARY TEE, REDUCING
STYLE NO. P401
ALL HUB



Diameter	Item No.	Master Qty	Skid Qty	List
2 x 1 1/2 x 1 1/2	05761	25	1,225	75.45
2 x 1 1/2 x 2	05760	25	875	90.95
2 x 2 x 1 1/2	05758	50	900	75.85
3 x 3 x 1 1/2	05764	20	560	163.60
3 x 3 x 2	05763	10	490	169.90
4 x 4 x 1 1/2	05767	5	280	431.50
4 x 4 x 2	05765	10	280	354.25
4 x 4 x 3	05766	10	180	481.30
6 x 6 x 4	05768	6	72	1,598.25

SANITARY TEE, STREET
STYLE NO. P403
SP x H x H



Diameter	Item No.	Master Qty	Skid Qty	List
1 1/2	06112	20	1,600	174.35
2	06113	25	875	169.20
3	06114	30	360	281.85
4	06120	10	160	711.95

SANITARY TEE, STREET, REDUCING
STYLE NO. P404
SP x H x H



Diameter	Item No.	Master Qty	Skid Qty	List
2 x 2 x 1 1/2	06117	50	1,400	148.95
3 x 3 x 1 1/2	06118	10	490	324.30
3 x 3 x 2	06119	20	560	278.55
4 x 4 x 2	06121	5	280	529.20

SANITARY TEE W / LEFT SIDE INLET
STYLE NO. P416
ALL HUB



Diameter	Item No.	Master Qty	Skid Qty	List
3 x 3 x 3 x 1 1/2	05781	10	280	635.35
3 x 3 x 3 x 2	05782	10	280	438.75
4 x 4 x 4 x 2	05784	5	140	1,022.05

SANITARY TEE W / RIGHT SIDE INLET
STYLE NO. P417
ALL HUB

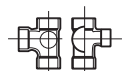

Diameter	Item No.	Master Qty	Skid Qty	List
3 x 3 x 3 x 1 1/2	05795	10	280	635.35
3 x 3 x 3 x 2	05796	10	280	438.75
4 x 4 x 4 x 2	05797	5	140	1,022.05

SANITARY TEE W / RIGHT & LEFT SIDE INLET
STYLE NO. P418
ALL HUB



Diameter	Item No.	Master Qty	Skid Qty	List
3 x 3 x 3 x 2 x 2	05811	5	245	643.30
4 x 4 x 4 x 2 x 2	05808	5	90	1,339.25

DOUBLE SANITARY TEE
STYLE NO. P428
ALL HUB



Diameter	Item No.	Master Qty	Skid Qty	List
1 1/2	05812	25	1,225	128.10
2	05813	20	700	173.05
3	05814	20	240	484.00
4	05815	4	112	778.60

DOUBLE SANITARY TEE, REDUCING
STYLE NO. P429
ALL HUB



Diameter	Item No.	Master Qty	Skid Qty	List
2 x 2 x 1 1/2 x 1 1/2	05817	20	980	135.90
3 x 3 x 1 1/2 x 1 1/2	05818	20	360	315.35
3 x 3 x 2 x 2	05820	10	350	342.70
4 x 4 x 2 x 2	05240	5	245	644.10
4 x 4 x 3 x 3	05821	5	140	668.30

DOUBLE SANITARY TEE W / SIDE INLET
STYLE NO. P438
ALL HUB

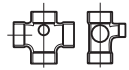

Diameter	Item No.	Master Qty	Skid Qty	List
3 x 3 x 3 x 3 x 2	05772	10	180	712.55
4 x 4 x 4 x 4 x 2	05774	10	120	1,566.40

DOUBLE SANITARY TEE W / RIGHT & LEFT SIDE INLET
STYLE NO. P439
ALL HUB



Diameter	Item No.	Master Qty	Skid Qty	List
3 x 3 x 3 x 3 x 2 x 2	05770	10	120	1,106.05

VENT TEE
STYLE NO. P441
ALL HUB



Diameter	Item No.	Master Qty	Skid Qty	List
1 1/2	06403	25	2,000	247.50
2	06404	25	1,225	185.30
3	06405	10	490	557.85
4	06406	5	245	798.15

CLEANOUT TEE WITH PLUG
STYLE NO. P444X
H x H x FPT



Diameter	Item No.	Master Qty	Skid Qty	List
1 1/2	05997	10	1,440	147.90
2	05998	10	800	171.50
3	05999	10	490	327.75
4	06000	5	175	566.00

FLUSH CLEANOUT TEE
STYLE NO. P445
H x H x FPT



Diameter	Item No.	Master Qty	Skid Qty	List
1 1/2	06413	20	2,240	119.90
2	06414	20	980	139.95
3	06415	10	490	271.45
4	06416	10	180	483.00
6	06422	5	60	2,440.60

FLUSH CLEANOUT TEE W / PLUG
STYLE NO. P445X
H x H x FPT



Diameter	Item No.	Master Qty	Skid Qty	List
2	05198	10	1,120	241.95
3	05199	10	490	390.00
4	05200	5	245	621.20

HORIZONTAL TWIN TEE
STYLE NO. P447
ALL HUB

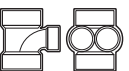

Diameter	Item No.	Master Qty	Skid Qty	List
3 x 3 x 1 1/2 x 1 1/2	05235	5	400	943.15

TWO-WAY CLEANOUT
STYLE NO. P448
ALL HUB



Diameter	Item No.	Master Qty	Skid Qty	List
3	05237	10	180	518.70
4	05238	5	90	671.35

HUB UTILITY TEE
STYLE NO. P449

Diameter	Item No.	Master Qty	Skid Qty	List
2	05794	20	560	468.10

DOUBLE FIXTURE FITTING
STYLE NO. P500
ALL HUB



Diameter	Item No.	Master Qty	Skid Qty	List
2	05246	10	560	294.70
2 x 1 1/2 x 1 1/2 x 1 1/2	05247	20	700	636.20
2 x 2 x 1 1/2 x 1 1/2	05244	20	700	362.60
3	05249	10	160	338.90

COMBINATION WYE & 1/8 BEND - ONE PIECE
STYLE NO. P501
ALL HUB



Diameter	Item No.	Master Qty	Skid Qty	List
1 1/2	05853	50	900	141.10
2	05858	20	560	176.10
3	05852	10	180	387.60
4	05860	10	120	763.70

COMBINATION WYE & 1/8 BEND, REDUCING - ONE PIECE
STYLE NO. P502
ALL HUB



Diameter	Item No.	Master Qty	Skid Qty	List
2 x 1 1/2 x 1 1/2	05835	5	720	279.10
2 x 2 x 1 1/2	05865	20	980	198.15
3 x 3 x 1 1/2	05837	15	420	353.40
3 x 3 x 2	05857	10	350	264.80
4 x 4 x 2	05863	5	175	398.85
4 x 4 x 3	05864	5	140	514.55

COMBINATION WYE & 1/8 BEND - TWO PIECE
STYLE NO. P503
ALL HUB



Diameter	Item No.	Master Qty	Skid Qty	List
6	05266	2	32	2,940.15
8	05273	1	8	4,436.80

COMBINATION WYE & 1/8 BEND, REDUCING - TWO PIECE
STYLE NO. P504
ALL HUB



Diameter	Item No.	Master Qty	Skid Qty	List
6 x 6 x 3	05271	5	60	2,644.45
6 x 6 x 4	05267	5	60	3,093.20
8 x 8 x 4	05272	1	16	2,681.65

DOUBLE COMBINATION WYE & 1/8 BEND, ASSEMBLED
STYLE NO. P507
ALL HUB



Diameter	Item No.	Master Qty	Skid Qty	List
2 x 1 1/2	06034	10	490	1,095.20
3	06032	10	120	2,000.20
3 x 2	06035	10	180	690.35
4	06033	5	60	1,131.15
4 x 2	06036	5	90	2,179.20
4 x 3	06037	5	80	1,845.45

COMBO WYE & 1/8 BEND W / LEFT SIDE INLET
STYLE NO. P515
ALL HUB



Diameter	Item No.	Master Qty	Skid Qty	List
3 x 3 x 3 x 2	06009	10	180	1,181.60

COMBO WYE & 1/8 BEND W / RIGHT SIDE INLET
STYLE NO. P516
ALL HUB



Diameter	Item No.	Master Qty	Skid Qty	List
3 x 3 x 3 x 2	06008	10	180	1,181.60

WYE
STYLE NO. P600
ALL HUB



Diameter	Item No.	Master Qty	Skid Qty	List
1 1/4	05816	35	1,715	158.90
1 1/2	05822	50	1,400	106.05
2	05823	25	875	104.40
3	05824	25	300	282.30
4	05825	5	140	511.95
6	06135	4	48	1,477.90
8	06139	1	16	2,605.65

WYE, REDUCING
STYLE NO. P601
ALL HUB



Diameter	Item No.	Master Qty	Skid Qty	List
2 x 1 1/2 x 1 1/2	05831	25	1,225	145.95
2 x 1 1/2 x 2	05832	10	800	225.95
2 x 2 x 1 1/2	05826	25	1,225	127.65
3 x 3 x 1 1/2	05827	15	525	188.75
3 x 3 x 2	05828	25	400	208.70
4 x 4 x 1 1/2	05833	5	175	652.80
4 x 4 x 2	05829	10	180	306.45
4 x 4 x 3	05830	10	160	415.60
6 x 6 x 3	06138	5	60	1,435.85
6 x 6 x 4	06137	5	60	1,193.35
8 x 8 x 4	06140	1	16	2,516.10
8 x 8 x 6	05834	1	16	2,594.40

PVC DWV FITTINGS

WYE, STREET STYLE NO. P602 SP x H x H



Diameter	Item No.	Master Qty	Skid Qty	List
1 1/2	06367	50	1,750	196.40
2	06368	30	840	188.40
3	06369	10	280	409.95
4	06370	10	120	839.35

WYE, STREET, REDUCING STYLE NO. P603 SP x H x H



Diameter	Item No.	Master Qty	Skid Qty	List
3 x 3 x 1 1/2	06372	20	360	475.25
3 x 3 x 2	06373	30	480	322.30
4 x 4 x 2	06374	10	180	958.25
4 x 4 x 3	06375	10	160	892.90

DOUBLE WYE STYLE NO. P611 ALL HUB



Diameter	Item No.	Master Qty	Skid Qty	List
1 1/2	05838	40	1,120	238.45
2	05839	20	560	283.00
3	05840	15	180	553.40
4	05841	5	80	1,192.55
6	05842	2	24	2,229.35

DOUBLE WYE W/ SIDE INLET STYLE NO. P611S ALL HUB



Diameter	Item No.	Master Qty	Skid Qty	List
3 x 3 x 3 x 3 x 2	05849	10	160	3,398.15

DOUBLE WYE, REDUCING STYLE NO. P612 ALL HUB



Diameter	Item No.	Master Qty	Skid Qty	List
2 x 2 x 1 1/2 x 1 1/2	05847	10	560	243.10
3 x 3 x 1 1/2 x 1 1/2	05843	10	350	506.65
3 x 3 x 2 x 2	05844	10	280	412.40
4 x 4 x 2 x 2	05845	5	175	673.10
4 x 4 x 3 x 3	05846	5	90	889.00
6 x 6 x 4 x 4	06142	1	16	3,119.25

WYE W/ LEFT SIDE INLET STYLE NO. P625 ALL HUB



Diameter	Item No.	Master Qty	Skid Qty	List
3 x 3 x 3 x 2	06155	5	175	1,397.80
4 x 4 x 4 x 2	06157	5	90	1,808.65

WYE W/ RIGHT SIDE INLET STYLE NO. P626 ALL HUB



Diameter	Item No.	Master Qty	Skid Qty	List
3 x 3 x 3 x 2	06156	5	175	1,397.80
4 x 4 x 4 x 2	06158	5	90	1,808.65

RETURN BEND STYLE NO. P700 H x H



Diameter	Item No.	Master Qty	Skid Qty	List
1 1/2	06466	20	1,600	105.85
2	06467	35	630	200.90
3	06468	10	280	563.90
4	06469	5	140	1,024.05

P-TRAP W/ SOLVENT WELD JOINT STYLE NO. P706X H x H



Diameter	Item No.	Master Qty	Skid Qty	List
1 1/2	05214	25	1,225	123.60
2	05222	20	560	150.60
3	05230	10	180	508.80
4	05231	4	72	1,225.10

P-TRAP W/ SOLVENT WELD JOINT & CLEAN OUT STYLE NO. P707X H x H



Diameter	Item No.	Master Qty	Skid Qty	List
1 1/2	05223	10	1,120	189.15
2	05224	10	560	329.00

P-TRAP W/ UNION STYLE NO. P708P H x H



Diameter	Item No.	Master Qty	Skid Qty	List
1 1/2	05215	25	875	147.35
2	05216	20	560	339.65

P-TRAP LOW PROFILE STYLE NO. P710 H x H



Diameter	Item No.	Master Qty	Skid Qty	List
2	05225	20	560	178.50

LA P-TRAP W/ UNION & 2 SIZE SJ WASHERS STYLE NO. P711P SJ x H (FURNISHED W/BOTH Diameter SJ WASHERS)



Diameter	Item No.	Master Qty	Skid Qty	List
1 1/4 x 1 1/2	05220	25	700	289.50

DRUM TRAP, W/ CLEANOUT STYLE NO. P720X H x H (W/PLUG)



Diameter	Item No.	Master Qty	Skid Qty	List
3 x 6 x 1 1/2	06100	15	420	484.65

CLOSET FLANGE STYLE NO. P800 H (ONE PIECE WITH SLOTS)

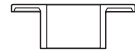

Diameter	Item No.	Master Qty	Skid Qty	List
4 x 4	05902	25	700	195.85

CLOSET FLANGE, W/ STOP STYLE NO. P800S (ONE PIECE WITH SLOTS)

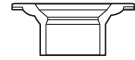

Diameter	Item No.	Master Qty	Skid Qty	List
4 x 3	05903	25	700	208.70

CLOSET FLANGE, KNOCK OUT STYLE NO. P800KO H (ONE PIECE WITH SLOTS & KNOCK OUT TEST CAP)

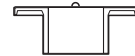

Diameter	Item No.	Master Qty	Skid Qty	List
4 x 3	05254	25	700	160.55
4 x 4	05253	25	700	287.65

CLOSET FLANGE, SPIGOT, REDUCING STYLE NO. P801 SP (ONE PIECE PLASTIC)

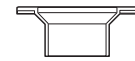

Diameter	Item No.	Master Qty	Skid Qty	List
4 x 3	05919	25	875	188.65

CLOSET FLANGE - HUB, ADJUSTABLE METAL RING, EPOXY COATED STYLE NO. P811 H (W/ SLOTS)

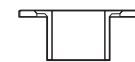

Diameter	Item No.	Master Qty	Skid Qty	List
4 x 3	05227	25	700	433.65
4 x 4	05226	25	700	450.05

CLOSET FLANGE - SPIGOT, ADJUSTABLE METAL RING, EPOXY COATED STYLE NO. P812 EPOXY COATED SP

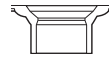

Diameter	Item No.	Master Qty	Skid Qty	List
4 x 3	05228	25	875	360.75
4 x 4	05229	25	700	505.75

CLOSET FLANGE, SPIGOT, ADJUSTABLE, W/ PLASTIC RING STYLE NO. P812P SP

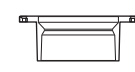

Diameter	Item No.	Master Qty	Skid Qty	List
4 x 3	05252	25	875	608.80
4 x 4	05264	25	700	712.85

FLUSH CLOSET FLANGE STYLE NO. P815 H (FITS OVER 3" OR INSIDE 4" SCH 40 DWV PIPE)

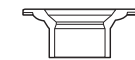

Diameter	Item No.	Master Qty	Skid Qty	List
4 x 4 / 4 x 3	05255	25	875	252.80

FLUSH CLOSET FLANGE, KNOCK OUT STYLE NO. P815KO H (FITS OVER 3" OR INSIDE 4" SCH 40 DWV PIPE)

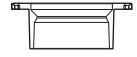

Diameter	Item No.	Master Qty	Skid Qty	List
4 x 4 / 4 x 3	05257	25	875	256.70

OFFSET CLOSET FLANGE - HUB, EPOXY COATED ADJUSTABLE METAL RING STYLE NO. P820 H

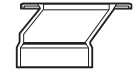

Diameter	Item No.	Master Qty	Skid Qty	List
4 x 3	05920	15	525	516.70