

The issuance of this price list is not an offer to sell the goods listed herein at the prices stated.

COUPLING
STYLE NO. P100
H x H 

Diameter	Item No.	Master Qty	Skid Qty	List
1 1/4	05932	100	8,000	13.45
1 1/2	05933	100	5,600	2.79
2	05934	100	4,900	3.83
3	05935	60	1,080	13.33
4	05936	25	700	22.65
6	06143	15	180	74.71
8	06145	6	72	124.15
12	06151	2	16	357.27

FEMALE ADAPTER
STYLE NO. P101
FPT x H 

Diameter	Item No.	Master Qty	Skid Qty	List
1 1/4	05868	100	8,000	29.78
1 1/2	05866	100	5,600	5.31
2	05867	100	4,900	9.07
3	05869	30	1,470	24.20
4	06396	10	560	31.24
6	06147	10	180	100.83

PIPE INCREASER / REDUCER
STYLE NO. P102
H x H 

Diameter	Item No.	Master Qty	Skid Qty	List
1 1/2 x 2	05948	25	3,600	8.54
1 1/2 x 3	05949	25	1,400	25.01
2 x 3	05950	20	1,600	19.35
2 x 4	05951	10	800	38.17
3 x 4	05952	20	1,120	40.80
4 x 6	05981	5	140	158.69

TRAP ADAPTER, MALE, W / 1 PIECE POLY NUT
STYLE NO. P103P
SP x SJ 

Diameter	Item No.	Master Qty	Skid Qty	List
1 1/2	06393	50	5,600	11.00
1 1/2 x 1 1/4	06379	75	6,000	11.95

TRAP ADAPTER, MALE, W / PLASTIC NUT & 1 1/2 X 1 1/4 WASHER
STYLE NO. P103R
SP x SJ 

Diameter	Item No.	Master Qty	Skid Qty	List
1 1/2 x 1 1/4	06389	50	5,600	11.78
1 1/2	06389	50	5,600	11.78

TRAP ADAPTER, MALE, W / PLASTIC NUT AND WASHER
STYLE NO. P103W
SP x SJ 

Diameter	Item No.	Master Qty	Skid Qty	List
1 1/2	06410	50	5,600	11.34
2	06390	25	3,600	46.20
1 1/2 x 1 1/4	06409	75	6,000	12.48

TRAP ADAPTER, MALE, W / CHROME NUT & WASHER
STYLE NO. P103X
SP x SJ 

Diameter	Item No.	Master Qty	Skid Qty	List
1 1/2	06392	50	5,600	14.78
1 1/2 x 1 1/4	06378	100	8,000	14.96

TRAP ADAPTER, FEMALE, W / 1 PIECE POLY NUT
STYLE NO. P104P
H x SJ 

Diameter	Item No.	Master Qty	Skid Qty	List
1 1/4	06381	50	5,600	11.25
1 1/2	06377	50	5,600	10.47
1 1/2 x 1 1/4	06395	50	5,600	10.53

TRAP ADAPTER, FEMALE W / P-NUT & WASHER
STYLE NO. P104R 

Diameter	Item No.	Master Qty	Skid Qty	List
1 1/2	06399	50	5,600	12.03

TRAP ADAPTER, FEMALE, W / PLASTIC NUT AND WASHER
STYLE NO. P104X
H x SJ 

Diameter	Item No.	Master Qty	Skid Qty	List
1 1/4	06380	50	5,600	8.83
1 1/2	06383	50	5,600	10.26
2	06382	25	3,600	16.83
1 1/2 x 1 1/4	06384	50	5,600	10.98

TRAP ADAPTER, FEMALE, W / CHROME NUT & WASHER
STYLE NO. P104X
H x SJ 

Diameter	Item No.	Master Qty	Skid Qty	List
1 1/2	06376	50	5,600	14.82
1 1/2 x 1 1/4	06394	50	5,600	14.37

FITTING CLEANOUT ADAPTER
STYLE NO. P105
SP x FPT 

Diameter	Item No.	Master Qty	Skid Qty	List
1 1/2	05922	50	7,200	6.78
2	05923	50	4,000	9.07
3	05924	25	1,225	24.35
4	05925	10	560	40.02
6	06148	10	280	113.95

SWIVEL FITTING CLEANOUT ADAPTER
STYLE NO. P105SW 

Diameter	Item No.	Master Qty	Skid Qty	List
1 1/2	06418	10	1,440	18.96

FITTING CLEANOUT ADAPTER, W / CLEANOUT PLUG
STYLE NO. P105X
SP x FPT 

Diameter	Item No.	Master Qty	Skid Qty	List
1 1/2	06001	50	5,600	11.72
2	06002	50	2,800	14.26
3	06003	25	875	34.38
4	06004	10	560	54.74
6	06005	10	180	159.99

CLEANOUT PLUG
STYLE NO. P106
MPT 

Diameter	Item No.	Master Qty	Skid Qty	List
1 1/2	05938	50	7,200	5.02
2	05939	50	7,200	5.62
3	05941	25	3,600	10.06
4	05942	30	2,400	14.82
6	06146	10	800	47.35

FLUSH BUSHING
STYLE NO. P107
SP x H STYLE #3 

Diameter	Item No.	Master Qty	Skid Qty	List
1 1/2 x 1 1/4	05904	100	14,400	11.18
2 x 1 1/4	05905	50	7,200	12.84
2 x 1 1/2	05906	50	7,200	4.84
3 x 1 1/2	05907	30	2,400	23.43
3 x 2	05908	30	2,400	12.27
4 x 2	05910	30	1,470	40.73
4 x 3	05909	30	1,470	20.91

FLANGE BUSHING, W / TUBE STOP
STYLE NO. P107S
SP x H STYLE #1 

Diameter	Item No.	Master Qty	Skid Qty	List
6 x 4	06144	10	490	104.62
8 x 6	06149	1	144	204.81

FLUSH BUSHING
STYLE NO. P108
SP x FPT STYLE #1 

Diameter	Item No.	Master Qty	Skid Qty	List
2 x 1 1/2	05913	50	7,200	27.97

MALE ADAPTER
STYLE NO. P109
H x MPT 

Diameter	Item No.	Master Qty	Skid Qty	List
1 1/4	05931	50	7,200	15.55
1 1/2	05927	50	5,600	5.35
2	05928	50	5,600	7.18
3	05929	25	1,400	20.05
4	05930	25	875	45.39
1 1/4 x 1 1/2	05926	25	3,600	7.74

FLUSH CLEANOUT PLUG
STYLE NO. P110
MPT 

Diameter	Item No.	Master Qty	Skid Qty	List
4	06015	25	2,800	21.46
2	06017	25	7,200	18.26
3	06018	50	5,600	21.25

MALE FITTING ADAPTER
STYLE NO. P111
SP x MPT 

Diameter	Item No.	Master Qty	Skid Qty	List
1 1/2	06386	50	7,200	23.07
2	06385	25	3,600	25.75
3	06366	25	1,225	39.83
1 1/2 x 1 1/4	06387	100	8,000	18.47

TRAY PLUG ADAPTER
STYLE NO. P113
H x NPSM THREAD 

Diameter	Item No.	Master Qty	Skid Qty	List
1 1/2	06014	10	2,160	15.55

CAP SOCKET
STYLE NO. P116
H 

Diameter	Item No.	Master Qty	Skid Qty	List
1 1/2	05977	10	2,880	11.31
2	05978	5	1,800	18.88
3	05979	10	1,440	31.57
4	05980	5	560	45.08
6	06057	5	175	113.82
8	06058	3	105	306.00

ADAPTER COUPLING
STYLE NO. P117
S/D H x DWV HUB (ADAPTS SEWER & DRAIN PIPE TO DWV PIPE) 

Diameter	Item No.	Master Qty	Skid Qty	List
3	05970	10	800	58.96
4	05963	10	560	44.28
4 x 3	05962	20	1,120	39.02

ADAPTER COUPLING
STYLE NO. P117X
S/D X DWV HUB (ADAPTS 4" S/D HUB TO 3" DWV Spigot PIPE) 

Diameter	Item No.	Master Qty	Skid Qty	List
4 x 3	05992	20	700	40.98

PVC DWV FITTINGS

ADAPTER BUSHING

STYLE NO. P118
DWV SP x SD H
(Adapts DWV Hub to S/D Spigot)



Diameter	Item No.	Master Qty	Skid Qty	List
3	05990	25	2,800	38.63
4	05991	10	1,440	16.87

NO HUB ADAPTER

STYLE NO. P119
NO H x H (Adapts CI NO HUB TO DWV PIPE)



Diameter	Item No.	Master Qty	Skid Qty	List
1 1/2	05802	25	3,600	36.97
2	05954	25	3,600	14.78
3	05955	20	1,600	21.45
4	05956	15	840	27.54
4 x 3	05953	10	1,120	49.03

SPIGOT ADAPTER, CAST IRON

STYLE NO. P122
ALL HUB (ADAPTS CI SPIGOT TO DWV PIPE)



Diameter	Item No.	Master Qty	Skid Qty	List
2	05944	10	1,440	55.23
4	05946	15	420	82.75

HUB ADAPTER, CAST IRON

STYLE NO. P123
SP x H (ADAPTS CI HUB TO DWV PIPE)



Diameter	Item No.	Master Qty	Skid Qty	List
2	05957	20	1,600	27.99
3	05958	20	700	53.10
4	05959	20	360	79.88

HUB ADAPTER, CAST IRON, INCREASER

STYLE NO. P123R
SP x H (ADAPTS CI HUB TO DWV PIPE)

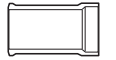

Diameter	Item No.	Master Qty	Skid Qty	List
2 x 1 1/2	05961	10	1,440	46.48
4 x 3	05960	10	490	60.56

REPAIR COUPLING

STYLE NO. P130
H x H



Diameter	Item No.	Master Qty	Skid Qty	List
1 1/2	05965	25	3,600	15.42
2	05966	25	3,600	10.75
3	05967	10	1,120	27.21
4	05968	5	560	52.35
6	05969	5	175	234.04

TEST CAP

STYLE NO. P131

Diameter	Item No.	Master Qty	Skid Qty	List
1 1/2	05411	4,500	54,000	6.33
2	05412	2,400	28,800	6.66
3	05413	600	10,800	6.90
4	05414	800	9,600	8.64

SLIP JOINT NUT

STYLE NO. P140



Diameter	Item No.	Master Qty	Skid Qty	List
1 1/2	05744	100	11,200	2.79
2	05741	100	8,000	4.62

1/4 BEND

STYLE NO. P300
H x H



Diameter	Item No.	Master Qty	Skid Qty	List
1 1/4	05875	100	3,500	20.81
1 1/2	05876	100	2,800	5.94
2	05877	50	1,400	9.35
3	05878	25	450	27.48
4	05879	10	180	54.27
6	06130	5	60	191.60
8	06131	1	28	247.54

1/4 BEND, REDUCING

STYLE NO. P300R
H x H



Diameter	Item No.	Master Qty	Skid Qty	List
2 x 1 1/2	06092	10	1,440	34.35

1/4 BEND, W / SIDE INLET

STYLE NO. P300S
H x H



Diameter	Item No.	Master Qty	Skid Qty	List
3 x 3 x 1 1/2	06069	10	490	80.50
3 x 3 x 2	06070	10	350	54.11

1/4 BEND, STREET

STYLE NO. P302
SP x H



Diameter	Item No.	Master Qty	Skid Qty	List
1 1/4	05894	35	3,920	31.47
1 1/2	05880	100	3,500	7.69
2	05881	50	1,750	11.79
3	05882	20	560	32.85
4	05883	10	180	55.25
6	05889	5	80	247.12

1/4 BEND, W / LOW HEEL INLET

STYLE NO. P303
H x H



Diameter	Item No.	Master Qty	Skid Qty	List
3 x 3 x 1 1/2	06041	25	400	59.54
3 x 3 x 2	06042	25	400	47.71
4 x 4 x 2	06043	15	180	94.19

LONG SWEEP 1/4 BEND

STYLE NO. P304
H x H



Diameter	Item No.	Master Qty	Skid Qty	List
1 1/2	05871	50	1,750	13.78
2	05872	25	1,225	15.34
3	05873	10	350	35.33
4	05874	5	175	67.06
6	06012	5	60	262.03

LONG SWEEP 1/4 BEND

STYLE NO. P305
W / HIGH HEEL INLET
H x H



Diameter	Item No.	Master Qty	Skid Qty	List
3 x 3 x 2	06027	25	300	227.70

LONG SWEEP 1/4 BEND

W / LOW HEEL INLET
STYLE NO. P307
H x H



Diameter	Item No.	Master Qty	Skid Qty	List
3 x 3 x 2	06024	25	300	106.81

LONG SWEEP 1/4 BEND, STREET

STYLE NO. P309
SP x H



Diameter	Item No.	Master Qty	Skid Qty	List
1 1/2	06060	50	2,450	21.25
2	06061	25	1,225	25.44
3	06063	20	360	63.32
4	06064	5	175	97.54

1/4 BEND W / LOW HEEL INLET

STYLE NO. P310
H x H x SP



Diameter	Item No.	Master Qty	Skid Qty	List
3 x 3 x 2	06026	15	420	136.45

LONG SWEEP 1/4 BEND W / SIDE INLET

STYLE NO. P311
H x H



Diameter	Item No.	Master Qty	Skid Qty	List
3 x 3 x 2	06050	25	300	153.49

1/6 BEND

STYLE NO. P319
H x H



Diameter	Item No.	Master Qty	Skid Qty	List
1 1/2	05895	40	3,200	13.92
2	05896	25	1,400	16.19
3	05897	20	560	59.80
4	05898	10	280	79.70

1/6 BEND, STREET

STYLE NO. P320
SP x H



Diameter	Item No.	Master Qty	Skid Qty	List
1 1/2	06020	40	3,200	25.25
2	06021	25	2,000	32.53
3	06022	20	700	70.16
4	06023	10	280	109.11

1/8 BEND

STYLE NO. P321
H x H



Diameter	Item No.	Master Qty	Skid Qty	List
1 1/4	05884	50	4,000	14.21
1 1/2	05885	100	3,500	5.81
2	05886	50	1,750	8.66
3	05887	20	560	24.61
4	05888	10	280	45.07
6	06132	3	84	167.90
8	06134	1	28	219.82

1/8 BEND, STREET

STYLE NO. P323
SP x H



Diameter	Item No.	Master Qty	Skid Qty	List
1 1/4	06016	40	4,480	19.44
1 1/2	05890	100	3,500	5.57
2	05891	50	1,750	8.84
3	05892	20	700	23.33
4	05893	10	280	40.00
6	06133	3	84	198.87
8	06136	1	28	238.58

1/16 BEND

STYLE NO. P324
H x H



Diameter	Item No.	Master Qty	Skid Qty	List
1 1/2	05899	50	4,000	8.26
2	05900	25	2,000	9.78
3	05901	20	700	24.28
4	05983	15	420	38.38
6	05988	3	84	221.66

1/16 BEND, STREET

STYLE NO. P326
SP x H



Diameter	Item No.	Master Qty	Skid Qty	List
1 1/2	05984	50	4,000	22.37
2	05985	25	2,800	23.93
3	05986	20	700	37.61
4	05987	10	490	54.57
6	06011	4	112	214.76

DOUBLE 1/4 BEND

STYLE NO. P327
H x H



Diameter	Item No.	Master Qty	Skid Qty	List
1 1/2	06045	20	1,600	23.53
2	06046	25	875	32.10
3	06047	10	280	83.86
2 x 1 1/2 x 1 1/2	06049	25	1,400	29.55

CLOSET BEND, REDUCING

STYLE NO. P329
H x H



Diameter	Item No.	Master Qty	Skid Qty	List
4 x 3	06093	10	280	44.19

CLOSET BEND, REDUCING

STYLE NO. P330
H x S



Diameter	Item No.	Master Qty	Skid Qty	List
4 x 3	06107	10	280	86.78

CLOSET BEND, REDUCING,

W / TEST CAP
STYLE NO. P330X
H x S



Diameter	Item No.	Master Qty	Skid Qty	List

VENT ELBOW
STYLE NO. P331
H x H



Diameter	Item No.	Master Qty	Skid Qty	List
1 1/2	06084	20	2,880	12.29
2	06085	30	1,680	15.96
3	06086	25	700	41.36

VENT ELBOW, STREET
STYLE NO. P333
H x SP



Diameter	Item No.	Master Qty	Skid Qty	List
1 1/2	06088	25	2,800	12.42
2	06089	20	2,240	18.47
3	06090	5	560	49.51

SANITARY TEE
STYLE NO. P400
ALL HUB



Diameter	Item No.	Master Qty	Skid Qty	List
1 1/4	05751	25	2,800	22.32
1 1/2	05752	100	1,800	10.35
2	05753	35	980	15.24
3	05754	30	360	40.14
4	05755	5	140	73.73
6	05756	6	72	296.08
8	05775	2	24	656.00

SANITARY TEE, REDUCING
STYLE NO. P401
ALL HUB



Diameter	Item No.	Master Qty	Skid Qty	List
2 x 1 1/2 x 1 1/2	05761	25	1,225	13.42
2 x 1 1/2 x 2	05760	25	875	16.28
2 x 2 x 1 1/2	05758	50	900	13.46
3 x 3 x 1 1/2	05764	20	560	29.33
3 x 3 x 2	05763	10	490	30.19
4 x 4 x 1 1/2	05767	5	280	77.31
4 x 4 x 2	05765	10	280	63.44
4 x 4 x 3	05766	10	180	86.23
6 x 6 x 4	05768	6	72	286.34

SANITARY TEE, STREET
STYLE NO. P403
SP x H x H



Diameter	Item No.	Master Qty	Skid Qty	List
1 1/2	06112	20	1,600	31.24
2	06113	25	875	30.30
3	06114	30	360	50.51
4	06120	10	160	127.54

SANITARY TEE, STREET, REDUCING
STYLE NO. P404
SP x H x H



Diameter	Item No.	Master Qty	Skid Qty	List
2 x 2 x 1 1/2	06117	50	1,400	26.70
3 x 3 x 1 1/2	06118	10	490	58.11
3 x 3 x 2	06119	20	560	49.90
4 x 4 x 2	06121	5	280	94.80

SANITARY TEE W / LEFT SIDE INLET
STYLE NO. P416
ALL HUB

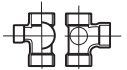

Diameter	Item No.	Master Qty	Skid Qty	List
3 x 3 x 3 x 1 1/2	05781	10	280	108.87
3 x 3 x 3 x 2	05782	10	280	72.63
4 x 4 x 4 x 2	05784	5	140	175.17

SANITARY TEE W / RIGHT SIDE INLET
STYLE NO. P417
ALL HUB

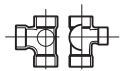

Diameter	Item No.	Master Qty	Skid Qty	List
3 x 3 x 3 x 1 1/2	05795	10	280	108.87
3 x 3 x 3 x 2	05796	10	280	72.63
4 x 4 x 4 x 2	05797	5	140	175.17

SANITARY TEE W / RIGHT & LEFT SIDE INLET
STYLE NO. P418
ALL HUB

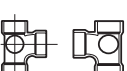

Diameter	Item No.	Master Qty	Skid Qty	List
3 x 3 x 3 x 2 x 2	05811	5	245	115.24
4 x 4 x 4 x 2 x 2	05808	5	90	209.75

DOUBLE SANITARY TEE
STYLE NO. P428
ALL HUB



Diameter	Item No.	Master Qty	Skid Qty	List
1 1/2	05812	25	1,225	22.96
2	05813	20	700	31.02
3	05814	20	240	86.73
4	05815	4	112	139.50

DOUBLE SANITARY TEE, REDUCING
STYLE NO. P429
ALL HUB



Diameter	Item No.	Master Qty	Skid Qty	List
2 x 2 x 1 1/2 x 1 1/2	05817	20	980	24.35
3 x 3 x 1 1/2 x 1 1/2	05818	20	360	56.48
3 x 3 x 2 x 2	05820	10	350	61.40
4 x 4 x 2 x 2	05240	5	245	115.37
4 x 4 x 3 x 3	05821	5	140	119.72

DOUBLE SANITARY TEE W / SIDE INLET
STYLE NO. P438
ALL HUB

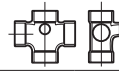

Diameter	Item No.	Master Qty	Skid Qty	List
3 x 3 x 3 x 3 x 2	05772	10	180	122.10
4 x 4 x 4 x 4 x 2	05774	10	120	259.77

DOUBLE SANITARY TEE W / RIGHT & LEFT SIDE INLET
STYLE NO. P439
ALL HUB



Diameter	Item No.	Master Qty	Skid Qty	List
3 x 3 x 3 x 3 x 2 x 2	05770	10	120	189.51

VENT TEE
STYLE NO. P441
ALL HUB



Diameter	Item No.	Master Qty	Skid Qty	List
1 1/2	06403	25	2,000	38.75
2	06404	25	1,225	31.75
3	06405	10	490	92.51
4	06406	5	245	132.38

CLEANOUT TEE WITH PLUG
STYLE NO. P444X
H x H x FPT



Diameter	Item No.	Master Qty	Skid Qty	List
1 1/2	05997	10	1,440	26.13
2	05998	10	1,120	30.30
3	05999	10	490	57.99
4	06000	5	175	100.27

FLUSH CLEANOUT TEE
STYLE NO. P445
H x H x FPT



Diameter	Item No.	Master Qty	Skid Qty	List
1 1/2	06413	20	2,240	21.10
2	06414	20	980	24.72
3	06415	10	490	47.93
4	06416	10	180	85.54
6	06422	5	60	430.12

FLUSH CLEANOUT TEE W / PLUG
STYLE NO. P445X
H x H x FPT



Diameter	Item No.	Master Qty	Skid Qty	List
2	05198	10	1,120	41.96
3	05199	10	490	67.32
4	05200	5	245	111.31

HORIZONTAL TWIN TEE
STYLE NO. P447
ALL HUB

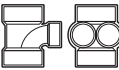

Diameter	Item No.	Master Qty	Skid Qty	List
3 x 3 x 1 1/2 x 1 1/2	05235	5	400	168.96

TWO-WAY CLEANOUT
STYLE NO. P448
ALL HUB



Diameter	Item No.	Master Qty	Skid Qty	List
3	05237	10	180	92.92
4	05238	5	90	120.28

HUB UTILITY TEE
STYLE NO. P449

Diameter	Item No.	Master Qty	Skid Qty	List
2	05794	20	560	83.86

DOUBLE FIXTURE FITTING
STYLE NO. P500
ALL HUB



Diameter	Item No.	Master Qty	Skid Qty	List
2	05246	20	560	52.79
3	05249	10	160	113.97
2 x 1 1/2 x 1 1/2 x 1 1/2	05247	20	700	64.98
2 x 2 x 1 1/2 x 1 1/2	05244	20	700	60.70

COMBINATION WYE & 1/8 BEND - ONE PIECE
STYLE NO. P501
ALL HUB



Diameter	Item No.	Master Qty	Skid Qty	List
1 1/2	05853	50	900	25.26
2	05858	20	560	31.55
3	05852	10	180	69.04
4	05860	10	120	136.80

COMBINATION WYE & 1/8 BEND, REDUCING - ONE PIECE
STYLE NO. P502
ALL HUB



Diameter	Item No.	Master Qty	Skid Qty	List
2 x 1 1/2 x 1 1/2	05835	5	720	48.41
2 x 2 x 1 1/2	05865	20	980	35.51
3 x 3 x 1 1/2	05837	15	420	63.32
3 x 3 x 2	05857	10	350	47.17
4 x 4 x 2	05863	5	175	71.46
4 x 4 x 3	05864	5	140	92.19

COMBINATION WYE & 1/8 BEND - TWO PIECE
STYLE NO. P503
ALL HUB



Diameter	Item No.	Master Qty	Skid Qty	List
6	05266	2	32	526.74
8	05273	2	8	794.85

COMBINATION WYE & 1/8 BEND, REDUCING - TWO PIECE
STYLE NO. P504
ALL HUB



Diameter	Item No.	Master Qty	Skid Qty	List
6 x 6 x 4	05267	5	60	473.76
6 x 6 x 3	05271	5	60	554.15
8 X 8 X 4	05272	1	16	480.41

DOUBLE COMBINATION WYE & 1/8 BEND, ASSEMBLED
STYLE NO. P507
ALL HUB



Diameter	Item No.	Master Qty	Skid Qty	List
3	06032	10	120	189.87
4	06033	5	60	358.34
2 x 1 1/2	06034	10	490	119.67
3 x 2	06035	10	180	202.67
4 x 2	06036	5	90	377.79
4 x 3	06037	5	80	330.62

COMBO WYE & 1/8 BEND W / LEFT SIDE INLET
STYLE NO. P515
ALL HUB



Diameter	Item No.	Master Qty	Skid Qty	List
3 x 3 x 3 x 2	06009	10	180	204.87

COMBO WYE & 1/8 BEND W / RIGHT SIDE INLET
STYLE NO. P516
ALL HUB



Diameter	Item No.	Master Qty	Skid Qty	List
3 x 3 x 3 x 2	06008	10	180	204.87

WYE
STYLE NO. P600
ALL HUB



Diameter	Item No.	Master Qty	Skid Qty	List
1 1/4	05816			

PVC DWV FITTINGS

WYE, REDUCING STYLE NO. P601 ALL HUB



Diameter	Item No.	Master Qty	Skid Qty	List
2 x 1 1/2 x 1 1/2	05831	25	1,225	26.13
2 x 1 1/2 x 2	05832	10	800	40.47
2 x 2 x 1 1/2	05826	25	875	22.85
3 x 3 x 1 1/2	05827	15	525	33.81
3 x 3 x 2	05828	25	400	37.09
4 x 4 x 1 1/2	05833	5	175	116.94
4 x 4 x 2	05829	10	180	54.90
4 x 4 x 3	05830	10	160	74.02
6 x 6 x 3	06138	5	60	257.24
6 x 6 x 4	06137	5	60	213.79
8 x 8 x 4	06140	1	16	450.79
8 x 8 x 6	05834	1	16	464.79

WYE, STREET STYLE NO. P602 SP x H x H



Diameter	Item No.	Master Qty	Skid Qty	List
1 1/2	06367	50	1,750	35.19
2	06368	30	840	33.75
3	06369	10	280	73.44
4	06370	10	120	150.37

WYE, STREET, REDUCING STYLE NO. P603 SP x H x H



Diameter	Item No.	Master Qty	Skid Qty	List
3 x 3 x 1 1/2	06372	20	360	82.43
3 x 3 x 2	06373	30	480	57.72
4 x 4 x 2	06374	10	180	171.66
4 x 4 x 3	06375	10	160	159.97

DOUBLE WYE STYLE NO. P611 ALL HUB



Diameter	Item No.	Master Qty	Skid Qty	List
1 1/2	05838	40	1,120	42.72
2	05839	20	560	50.69
3	05840	15	180	99.14
4	05841	5	80	213.66
6	05842	2	24	399.40

DOUBLE WYE W/ SIDE INLET STYLE NO. P611S ALL HUB



Diameter	Item No.	Master Qty	Skid Qty	List
3 x 3 x 3 x 3 x 2	05849	10	160	563.52

DOUBLE WYE, REDUCING STYLE NO. P612 ALL HUB



Diameter	Item No.	Master Qty	Skid Qty	List
2 x 2 x 1 1/2 x 1 1/2	05847	10	560	43.54
3 x 3 x 1 1/2 x 1 1/2	05843	10	350	86.81
3 x 3 x 2 x 2	05844	10	280	73.89
4 x 4 x 2 x 2	05845	5	175	120.60
4 x 4 x 3 x 3	05846	5	90	159.26
6 x 6 x 4 x 4	06142	1	16	558.84

WYE W/ LEFT SIDE INLET STYLE NO. P625 ALL HUB



Diameter	Item No.	Master Qty	Skid Qty	List
3 x 3 x 3 x 2	06155	5	175	228.87
4 x 4 x 4 x 2	06157	5	90	324.01

WYE W/ RIGHT SIDE INLET STYLE NO. P626 ALL HUB



Diameter	Item No.	Master Qty	Skid Qty	List
3 x 3 x 3 x 2	06156	5	175	228.87
4 x 4 x 4 x 2	06158	5	90	324.01

RETURN BEND STYLE NO. P700 H x H



Diameter	Item No.	Master Qty	Skid Qty	List
1 1/2	06466	20	1,600	18.94
2	06467	35	630	36.02
3	06468	10	280	101.02
4	06469	5	140	183.46

P-TRAP W/ SOLVENT WELD JOINT STYLE NO. P706X H x H



Diameter	Item No.	Master Qty	Skid Qty	List
1 1/2	05214	25	1,225	22.03
2	05222	20	560	26.80
3	05230	10	180	91.14
4	05231	4	72	219.50

P-TRAP W/ SOLVENT WELD JOINT & CLEAN OUT STYLE NO. P707X H x H



Diameter	Item No.	Master Qty	Skid Qty	List
1 1/2	05223	10	1,120	33.87
2	05224	10	560	58.96

P-TRAP W/ UNION STYLE NO. P708P H x H



Diameter	Item No.	Master Qty	Skid Qty	List
1 1/2	05215	25	875	26.39
2	05216	20	560	60.82

P-TRAP LOW PROFILE STYLE NO. P710 H x H



Diameter	Item No.	Master Qty	Skid Qty	List
2	05225	20	560	29.25

LA P-TRAP W/ UNION & 2 SIZE SJ WASHERS STYLE NO. P711P SJ x H (FURNISHED W/BOTH Diameter SJ WASHERS)



Diameter	Item No.	Master Qty	Skid Qty	List
1 1/4 x 1 1/2	05220	25	700	50.19
1 1/2	05220	25	700	50.19

DRUM TRAP, W/ CLEANOUT STYLE NO. P720X H x H (W/PLUG)



Diameter	Item No.	Master Qty	Skid Qty	List
3 x 6 x 1 1/2	06100	15	420	80.23

CLOSET FLANGE STYLE NO. P800 H (ONE PIECE WITH SLOTS)



Diameter	Item No.	Master Qty	Skid Qty	List
4 x 4	05902	25	700	35.08

CLOSET FLANGE, W/ STOP STYLE NO. P800S (ONE PIECE WITH SLOTS)



Diameter	Item No.	Master Qty	Skid Qty	List
4 x 3	05903	25	700	32.68

CLOSET FLANGE, KNOCK OUT STYLE NO. P800KO H (ONE PIECE WITH SLOTS & KNOCK OUT TEST CAP)

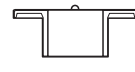

Diameter	Item No.	Master Qty	Skid Qty	List
4 x 3	05254	25	700	28.74
4 x 4	05253	25	700	51.52

CLOSET FLANGE, SPIGOT, REDUCING STYLE NO. P801 SP (ONE PIECE PLASTIC)

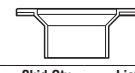

Diameter	Item No.	Master Qty	Skid Qty	List
4 x 3	05919	25	875	33.79

CLOSET FLANGE - HUB, ADJUSTABLE PLASTIC RING STYLE NO. P810 H (W/ SLOTS)

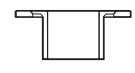

Diameter	Item No.	Master Qty	Skid Qty	List
4 x 4	05256*	25	700	42.59

CLOSET FLANGE - HUB, ADJUSTABLE METAL RING, EPOXY COATED STYLE NO. P811 H (W/ SLOTS)

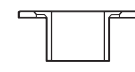

Diameter	Item No.	Master Qty	Skid Qty	List
4 x 3	05227	25	700	71.04
4 x 4	05226	25	700	80.62

CLOSET FLANGE - SPIGOT, ADJUSTABLE METAL RING, EPOXY COATED STYLE NO. P812 EPOXY COATED SP



Diameter	Item No.	Master Qty	Skid Qty	List
4 x 3	05228	25	875	64.63
4 x 4	05229	25	700	82.81

CLOSET FLANGE, SPIGOT, ADJUSTABLE, W/ PLASTIC RING STYLE NO. P812P SP



Diameter	Item No.	Master Qty	Skid Qty	List
4 x 3	05252	25	875	92.11
4 x 4	05264	25	700	111.65

FLUSH CLOSET FLANGE STYLE NO. P815 H (FITS OVER 3" OR INSIDE 4" SCH 40 DWV PIPE)



Diameter	Item No.	Master Qty	Skid Qty	List
4 x 4 / 4 x 3	05255	25	875	45.29

FLUSH CLOSET FLANGE, KNOCK OUT STYLE NO. P815KO H (FITS OVER 3" OR INSIDE 4" SCH 40 DWV PIPE)

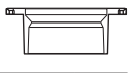

Diameter	Item No.	Master Qty	Skid Qty	List
4 x 4 / 4 x 3	05257	25	875	45.98

OFFSET CLOSET FLANGE - HUB, EPOXY COATED ADJUSTABLE METAL RING STYLE NO. P820 H

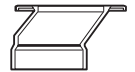

Diameter	Item No.	Master Qty	Skid Qty	List
4 x 3	05920	15	525	92.56