

**PVC DWV FITTINGS**

**UW PDF0526**

Effective May 4, 2026  
(Supersedes UW PDF0426)

The issuance of this price list is not an offer to sell the goods listed herein at the prices stated.

**COUPLING**  
STYLE NO. P100  
H x H



Diameter	Item No.	Master Qty	Skid Qty	List
1 1/4	05932	100	8,000	88.55
1 1/2	05933	100	5,600	18.50
2	05934	100	4,900	25.35
3	05935	60	1,080	88.55
4	05936	25	700	150.50
6	06143	15	180	491.95
8	06145	6	72	817.55

**FEMALE ADAPTER**  
STYLE NO. P101  
FPT x H



Diameter	Item No.	Master Qty	Skid Qty	List
1 1/4	05868	100	8,000	195.95
1 1/2	05866	100	5,600	35.10
2	05867	100	4,900	59.75
3	05869	25	1,470	159.35
4	06396	10	560	207.00
6	06147	10	180	663.90

**PIPE INCREASER / REDUCER**  
STYLE NO. P102  
H x H



Diameter	Item No.	Master Qty	Skid Qty	List
1 1/2 x 2	05948	25	3,600	56.20
1 1/2 x 3	05949	25	1,400	164.60
2 x 3	05950	20	1,600	128.25
2 x 4	05951	10	800	251.35
3 x 4	05952	20	1,120	268.75
4 x 6	05981	5	140	1,044.95

**TRAP ADAPTER, MALE, W / 1 PIECE POLY NUT**  
STYLE NO. P103P  
SP x SJ



Diameter	Item No.	Master Qty	Skid Qty	List
1 1/2 x 1 1/4	06379	75	6,000	72.55
1 1/2	06393	50	5,600	78.75

**TRAP ADAPTER, MALE, W / PLASTIC NUT & WASHER**  
STYLE NO. P103R  
SP x SJ



Diameter	Item No.	Master Qty	Skid Qty	List
1 1/2 x 1 1/4	06389	50	5,600	77.50
1 1/2	06389	50	5,600	77.50

**TRAP ADAPTER, MALE, W / PLASTIC NUT AND WASHER**  
STYLE NO. P103W  
SP x SJ



Diameter	Item No.	Master Qty	Skid Qty	List
1 1/2	06410	50	5,600	74.75
2	06390	25	3,600	393.95
1 1/2 x 1 1/4	06409	75	6,000	94.05

**TRAP ADAPTER, MALE, W / CHROME NUT & WASHER**  
STYLE NO. P103X  
SP x SJ



Diameter	Item No.	Master Qty	Skid Qty	List
1 1/2	06378	100	8,000	97.25
1 1/2	06392	50	5,600	98.40

**TRAP ADAPTER, FEMALE, W / 1 PIECE POLY NUT**  
STYLE NO. P104P  
H x SJ



Diameter	Item No.	Master Qty	Skid Qty	List
1 1/4	06381	50	5,600	84.75
1 1/2 x 1 1/4	06395	50	5,600	69.00
1 1/2	06377	50	5,600	69.50

**TRAP ADAPTER, FEMALE W / P-NUT & WASHER**  
STYLE NO. P104R

Diameter	Item No.	Master Qty	Skid Qty	List
1 1/2	06399	50	5,600	79.20

**TRAP ADAPTER, FEMALE, W / PLASTIC NUT AND WASHER**  
STYLE NO. P104W  
H x SJ



Diameter	Item No.	Master Qty	Skid Qty	List
1 1/4	06380	50	5,600	75.25
1 1/2 x 1 1/4	06384	50	5,600	73.00
1 1/2	06383	50	5,600	143.65
2	06382	25	3,600	72.20

**TRAP ADAPTER, FEMALE, W / CHROME NUT & WASHER**  
STYLE NO. P104X  
H x SJ



Diameter	Item No.	Master Qty	Skid Qty	List
1 1/2	06376	50	5,600	97.60
1 1/2 x 1 1/4	06394	50	5,600	94.60

**FITTING CLEANOUT ADAPTER**  
STYLE NO. P105  
SP x FPT



Diameter	Item No.	Master Qty	Skid Qty	List
1 1/2	05922	50	7,200	44.65
2	05923	50	4,000	59.75
3	05924	25	1,225	160.35
4	05925	10	560	263.60
6	06148	10	280	750.30

**SWIVEL FITTING CLEANOUT ADAPTER**  
STYLE NO. P105SW

Diameter	Item No.	Master Qty	Skid Qty	List
1 1/2	06418	30	4,320	161.65

**FITTING CLEANOUT ADAPTER, W / CLEANOUT PLUG**  
STYLE NO. P105X  
SP x FPT



Diameter	Item No.	Master Qty	Skid Qty	List
1 1/2	06001	50	5,600	77.80
2	06002	50	2,800	97.00
3	06003	25	875	226.55
4	06004	10	560	361.65
6	06005	10	180	1,062.10

**CLEANOUT PLUG**  
STYLE NO. P106  
MPT



Diameter	Item No.	Master Qty	Skid Qty	List
1 1/2	05938	50	7,200	33.15
2	05939	50	7,200	37.25
3	05941	25	3,600	66.20
4	05942	20	2,400	98.15
6	06146	10	800	311.70

**FLUSH BUSHING**  
STYLE NO. P107  
SP x H STYLE #3



Diameter	Item No.	Master Qty	Skid Qty	List
1 1/2 x 1 1/4	05904	100	14,400	73.95
2 x 1 1/4	05905	50	7,200	88.40
2 x 1 1/2	05906	50	7,200	32.35
3 x 1 1/2	05907	30	2,400	154.25
3 x 2	05908	30	2,400	81.50
4 x 2	05910	30	1,470	268.15
4 x 3	05909	30	1,470	138.60

**FLANGE BUSHING, W / TUBE STOP**  
STYLE NO. P107S  
SP x H STYLE #1



Diameter	Item No.	Master Qty	Skid Qty	List
6 x 4	06144	10	490	688.95
8 x 6	06149	1	144	1,348.75

**FLUSH BUSHING**  
STYLE NO. P108  
SP x FPT STYLE #1



Diameter	Item No.	Master Qty	Skid Qty	List
2 x 1 1/2	05913	50	7,200	198.90

**MALE ADAPTER**  
STYLE NO. P109  
H x MPT



Diameter	Item No.	Master Qty	Skid Qty	List
1 1/4	05931	50	7,200	110.60
1 1/4 x 1 1/2	05926	25	3,600	35.20
1 1/2	05927	50	5,600	47.15
2	05928	50	5,600	131.95
3	05929	25	1,400	298.75
4	05930	25	875	50.85

**FLUSH CLEANOUT PLUG**  
STYLE NO. P110  
MPT

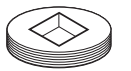

Diameter	Item No.	Master Qty	Skid Qty	List
2	06017	25	7,200	163.50
3	06018	50	7,200	120.20
4	06015	25	3,600	139.85

**MALE FITTING ADAPTER**  
STYLE NO. P111  
SP x MPT



Diameter	Item No.	Master Qty	Skid Qty	List
1 1/2	06386	50	7,200	152.05
1 1/2 x 1 1/4	06387	100	8,000	169.65
2	06385	25	3,600	310.60
3	06366	25	1,225	139.05

**TRAY PLUG ADAPTER**  
STYLE NO. P113  
H x NPSM THREAD



Diameter	Item No.	Master Qty	Skid Qty	List
1 1/2	06014	10	2,160	102.30

**CAP SOCKET**  
STYLE NO. P116  
H



Diameter	Item No.	Master Qty	Skid Qty	List
1 1/2	05977	10	2,880	74.65
2	05978	5	1,800	124.40
3	05979	10	1,440	208.05
4	05980	5	560	296.70
6	06057	5	175	749.50
8	06058	3	63	2,014.90

**ADAPTER COUPLING**  
STYLE NO. P117  
S/D H x DWV HUB (ADAPTS SEWER & DRAIN PIPE TO DWV PIPE)



Diameter	Item No.	Master Qty	Skid Qty	List
3	05970	10	800	502.95
4	05963	10	560	291.55
4 x 3	05962	20	1,120	280.95

**ADAPTER COUPLING**  
STYLE NO. P117X  
S/D X DWV HUB (ADAPTS 4" S/D HUB TO 3" DWV Spigot PIPE)



Diameter	Item No.	Master Qty	Skid Qty	List
4 x 3	05992	20	700	319.45

## PVC DWV FITTINGS

### ADAPTER BUSHING

STYLE NO. P118  
DWV SP x SD H  
(Adapts DWV Hub to S/D Spigot)



Diameter	Item No.	Master Qty	Skid Qty	List
3	05990	25	2,800	254.35
4	05991	10	1,440	111.10

### NO HUB ADAPTER

STYLE NO. P119  
NO H x H (Adapts CI NO HUB TO DWV PIPE)



Diameter	Item No.	Master Qty	Skid Qty	List
1 1/2	05802	25	3,600	243.35
2	05954	25	3,600	97.25
3	05955	20	1,600	141.45
4	05956	15	840	181.30
4 x 3	05953	10	1,120	348.70

### SPIGOT ADAPTER, CAST IRON

STYLE NO. P122  
ALL HUB (ADAPTS CI SPIGOT TO DWV PIPE)



Diameter	Item No.	Master Qty	Skid Qty	List
2	05944	10	1,440	363.75
4	05946	15	420	544.95

### HUB ADAPTER, CAST IRON

STYLE NO. P123  
SP x H (ADAPTS CI HUB TO DWV PIPE)



Diameter	Item No.	Master Qty	Skid Qty	List
2	05957	20	1,600	184.35
3	05958	20	700	349.75
4	05959	20	360	526.00

### HUB ADAPTER, CAST IRON, INCREASER

STYLE NO. P123R  
SP x H (ADAPTS CI HUB TO DWV PIPE)

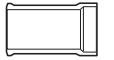

Diameter	Item No.	Master Qty	Skid Qty	List
2 X 1 1/2 X 2	05961	10	1,440	349.95
4 X 3	05960	10	490	398.70

### REPAIR COUPLING

STYLE NO. P130  
H x H



Diameter	Item No.	Master Qty	Skid Qty	List
1 1/2	05965	25	3,600	101.70
2	05966	25	3,600	70.80
3	05967	10	1,120	179.25
4	05968	5	560	344.70
6	05969	5	175	1,541.15

### TEST CAP

STYLE NO. P131

Diameter	Item No.	Master Qty	Skid Qty	List
1 1/2	05411	100	54,000	41.60
2	05412	100	28,800	43.90
3	05413	50	10,800	45.35
4	05414	50	9,600	56.80

### SLIP JOINT NUT

STYLE NO. P140



Diameter	Item No.	Master Qty	Skid Qty	List
1 1/2	05744	100	11,200	13.82
2	05741	100	8,000	25.46

### 1/4 BEND

STYLE NO. P300  
H x H



Diameter	Item No.	Master Qty	Skid Qty	List
1 1/4	05875	100	3,500	137.10
1 1/2	05876	100	2,800	39.25
2	05877	50	1,400	62.05
3	05878	25	450	182.45
4	05879	10	180	360.15
6	06130	5	60	1,261.45
8	06131	1	28	1,629.95

### 1/4 BEND, REDUCING

STYLE NO. P300R  
H x H



Diameter	Item No.	Master Qty	Skid Qty	List
2 x 1 1/2	06092	10	1,440	226.10

### 1/4 BEND, W / SIDE INLET

STYLE NO. P300S  
H x H



Diameter	Item No.	Master Qty	Skid Qty	List
3 x 3 x 1 1/2	06069	10	490	529.95
3 x 3 x 2	06070	10	350	356.35

### 1/4 BEND, STREET

STYLE NO. P302  
SP x H



Diameter	Item No.	Master Qty	Skid Qty	List
1 1/4	05894	35	3,920	223.75
1 1/2	05880	100	3,500	50.85
2	05881	50	1,750	78.15
3	05882	15	560	217.65
4	05883	10	180	364.05
6	05889	5	80	1,627.25

### 1/4 BEND, W / LOW HEEL INLET

STYLE NO. P303  
H x H



Diameter	Item No.	Master Qty	Skid Qty	List
3 x 3 x 1 1/2	06041	25	400	392.15
3 x 3 x 2	06042	25	400	314.10
4 x 4 x 2	06043	15	180	620.30

### LONG SWEEP 1/4 BEND

STYLE NO. P304  
H x H



Diameter	Item No.	Master Qty	Skid Qty	List
1 1/2	05871	50	1,750	91.15
2	05872	20	1,225	101.85
3	05873	10	350	234.50
4	05874	5	175	442.50
6	06012	5	60	1,725.30

### LONG SWEEP 1/4 BEND

STYLE NO. P305  
W / HIGH HEEL INLET  
H x H



Diameter	Item No.	Master Qty	Skid Qty	List
3 x 3 x 2	06027	25	300	1,714.90

### LONG SWEEP 1/4 BEND

W / LOW HEEL INLET  
STYLE NO. P307  
H x H



Diameter	Item No.	Master Qty	Skid Qty	List
3 x 3 x 2	06024	25	300	703.45

### LONG SWEEP 1/4 BEND, STREET

STYLE NO. P309  
SP x H



Diameter	Item No.	Master Qty	Skid Qty	List
1 1/2	06060	50	2,450	139.85
2	06061	25	1,225	167.50
3	06063	20	360	416.90
4	06064	5	175	642.20

### 1/4 BEND W / LOW HEEL INLET

STYLE NO. P310  
H x H x SP



Diameter	Item No.	Master Qty	Skid Qty	List
3 x 3 x 2	06026	15	420	898.60

### LONG SWEEP 1/4 BEND W / SIDE INLET

STYLE NO. P311  
H x H



Diameter	Item No.	Master Qty	Skid Qty	List
3 x 3 x 2	06050	25	300	1,044.25

### 1/6 BEND

STYLE NO. P319  
H x H



Diameter	Item No.	Master Qty	Skid Qty	List
1 1/2	05895	40	3,200	91.70
2	05896	25	1,400	106.70
3	05897	20	560	393.75
4	05898	10	280	524.90

### 1/6 BEND, STREET

STYLE NO. P320  
SP x H



Diameter	Item No.	Master Qty	Skid Qty	List
1 1/2	06020	40	3,200	166.35
2	06021	25	2,000	214.25
3	06022	20	700	462.00
4	06023	10	280	718.50

### 1/8 BEND

STYLE NO. P321  
H x H



Diameter	Item No.	Master Qty	Skid Qty	List
1 1/4	05884	50	4,000	93.50
1 1/2	05885	100	3,500	38.50
2	05886	50	1,750	57.45
3	05887	20	560	163.50
4	05888	10	280	299.10
6	06132	3	84	1,105.50
8	06134	1	28	1,447.40

### 1/8 BEND, STREET

STYLE NO. P323  
SP x H



Diameter	Item No.	Master Qty	Skid Qty	List
1 1/4	06016	40	4,480	128.05
1 1/2	05890	100	3,500	36.90
2	05891	50	1,750	58.75
3	05892	20	700	154.85
4	05893	10	280	265.40
6	06133	3	84	1,309.70
8	06136	1	28	1,570.80

### 1/16 BEND

STYLE NO. P324  
H x H



Diameter	Item No.	Master Qty	Skid Qty	List
1 1/2	05899	50	4,000	54.70
2	05900	25	2,000	64.90
3	05901	20	700	159.85
4	05983	15	420	252.75
6	05988	3	84	1,459.50

### 1/16 BEND, STREET

STYLE NO. P326  
SP x H



Diameter	Item No.	Master Qty	Skid Qty	List
1 1/2	05984	50	4,000	148.25
2	05985	25	2,800	158.90
3	05986	20	700	247.55
4	05987	15	490	359.30
6	06011	4	112	1,414.05

### DOUBLE 1/4 BEND

STYLE NO. P327  
H x H



Diameter	Item No.	Master Qty	Skid Qty	List
1 1/2	06045	20	1,600	154.85
2	06046	25	875	211.30
2 x 1 1/2 x 1 1/2	06049	25	1,400	552.20
3	06047	10	280	194.60

### CLOSET BEND, REDUCING

STYLE NO. P329  
H x H



Diameter	Item No.	Master Qty	Skid Qty	List
4 x 3	06093	10	280	293.35

### CLOSET BEND, REDUCING

STYLE NO. P330  
H x S



Diameter	Item No.	Master Qty	Skid Qty	List
4 x 3	06107	10	280	571.25

### CLOSET BEND, REDUCING,

W / TEST CAP  
STYLE NO. P330X  
H x S



**PVC DWV FITTINGS**

**SANITARY TEE  
STYLE NO. P400  
ALL HUB**



Diameter	Item No.	Master Qty	Skid Qty	List
1 1/4	05751	25	2,800	146.95
1 1/2	05752	100	1,800	68.80
2	05753	35	980	101.00
3	05754	30	360	265.95
4	05755	5	140	485.55
6	05756	6	72	1,949.50
8	05775	2	24	4,319.70

**SANITARY TEE, REDUCING  
STYLE NO. P401  
ALL HUB**



Diameter	Item No.	Master Qty	Skid Qty	List
2 x 1 1/2 x 1 1/2	05761	25	1,225	89.05
2 x 1 1/2 x 2	05760	25	875	107.30
2 x 2 x 1 1/2	05758	50	900	89.45
3 x 3 x 1 1/2	05764	20	560	193.00
3 x 3 x 2	05763	10	490	200.45
4 x 4 x 1 1/2	05767	5	280	509.05
4 x 4 x 2	05765	10	280	417.90
4 x 4 x 3	05766	10	180	567.75
6 x 6 x 4	05768	6	72	1,885.40

**SANITARY TEE, STREET  
STYLE NO. P403  
SP x H x H**



Diameter	Item No.	Master Qty	Skid Qty	List
1 1/2	06112	20	1,600	205.65
2	06113	25	875	199.65
3	06114	30	360	332.50
4	06120	10	160	839.90

**SANITARY TEE, STREET, REDUCING  
STYLE NO. P404  
SP x H x H**



Diameter	Item No.	Master Qty	Skid Qty	List
2 x 2 x 1 1/2	06117	50	1,400	175.70
3 x 3 x 1 1/2	06118	10	490	382.55
3 x 3 x 2	06119	20	560	328.60
4 x 4 x 2	06121	5	280	624.30

**SANITARY TEE W / LEFT SIDE INLET  
STYLE NO. P416  
ALL HUB**



Diameter	Item No.	Master Qty	Skid Qty	List
3 x 3 x 3 x 1 1/2	05781	10	280	749.50
3 x 3 x 3 x 2	05782	10	280	517.55
4 x 4 x 4 x 2	05784	5	140	1,205.65

**SANITARY TEE W / RIGHT SIDE INLET  
STYLE NO. P417  
ALL HUB**

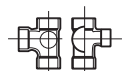

Diameter	Item No.	Master Qty	Skid Qty	List
3 x 3 x 3 x 1 1/2	05795	10	280	749.50
3 x 3 x 3 x 2	05796	10	280	517.55
4 x 4 x 4 x 2	05797	5	140	1,205.65

**SANITARY TEE W / RIGHT & LEFT SIDE INLET  
STYLE NO. P418  
ALL HUB**



Diameter	Item No.	Master Qty	Skid Qty	List
3 x 3 x 3 x 2 x 2	05811	5	245	758.90
4 x 4 x 4 x 2 x 2	05808	5	90	1,579.85

**DOUBLE SANITARY TEE  
STYLE NO. P428  
ALL HUB**



Diameter	Item No.	Master Qty	Skid Qty	List
1 1/2	05812	25	1,225	151.10
2	05813	20	700	204.10
3	05814	20	240	570.95
4	05815	4	112	918.45

**DOUBLE SANITARY TEE, REDUCING  
STYLE NO. P429  
ALL HUB**



Diameter	Item No.	Master Qty	Skid Qty	List
2 x 2 x 1 1/2 x 1 1/2	05817	20	980	160.35
3 x 3 x 1 1/2 x 1 1/2	05818	20	360	372.00
3 x 3 x 2 x 2	05820	10	350	404.30
4 x 4 x 2 x 2	05240	5	245	759.80
4 x 4 x 3 x 3	05821	5	140	788.40

**DOUBLE SANITARY TEE W / SIDE INLET  
STYLE NO. P438  
ALL HUB**

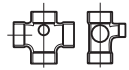

Diameter	Item No.	Master Qty	Skid Qty	List
3 x 3 x 3 x 3 x 2	05772	10	180	840.60
4 x 4 x 4 x 4 x 2	05774	10	120	1,847.80

**DOUBLE SANITARY TEE W / RIGHT & LEFT SIDE INLET  
STYLE NO. P439  
ALL HUB**



Diameter	Item No.	Master Qty	Skid Qty	List
3 x 3 x 3 x 3 x 2 x 2	05770	10	120	1,304.75

**VENT TEE  
STYLE NO. P441  
ALL HUB**



Diameter	Item No.	Master Qty	Skid Qty	List
1 1/2	06403	25	2,000	291.95
2	06404	25	1,225	218.60
3	06405	10	490	658.10
4	06406	5	245	941.55

**CLEANOUT TEE WITH PLUG  
STYLE NO. P444X  
H x H x FPT**



Diameter	Item No.	Master Qty	Skid Qty	List
1 1/2	05997	10	1,440	174.45
2	05998	10	800	202.30
3	05999	10	490	386.60
4	06000	5	175	667.65

**FLUSH CLEANOUT TEE  
STYLE NO. P445  
H x H x FPT**



Diameter	Item No.	Master Qty	Skid Qty	List
1 1/2	06413	20	2,240	141.45
2	06414	20	980	165.10
3	06415	10	490	320.25
4	06416	10	180	569.75
6	06422	5	60	2,879.05

**FLUSH CLEANOUT TEE W / PLUG  
STYLE NO. P445X  
H x H x FPT**



Diameter	Item No.	Master Qty	Skid Qty	List
2	05198	10	1,120	285.45
3	05199	10	490	460.05
4	05200	5	245	732.80

**HORIZONTAL TWIN TEE  
STYLE NO. P447  
ALL HUB**

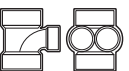

Diameter	Item No.	Master Qty	Skid Qty	List
3 x 3 x 1 1/2 x 1 1/2	05235	5	400	1,112.60

**TWO-WAY CLEANOUT  
STYLE NO. P448  
ALL HUB**



Diameter	Item No.	Master Qty	Skid Qty	List
3	05237	10	180	611.90
4	05238	5	90	791.95

**HUB UTILITY TEE  
STYLE NO. P449**

Diameter	Item No.	Master Qty	Skid Qty	List
2	05794	20	560	552.20

**DOUBLE FIXTURE FITTING  
STYLE NO. P500  
ALL HUB**



Diameter	Item No.	Master Qty	Skid Qty	List
2	05246	10	560	347.65
2 x 1 1/2 x 1 1/2 x 1 1/2	05247	20	700	750.50
2 x 2 x 1 1/2 x 1 1/2	05244	20	700	427.75
3	05249	10	160	399.80

**COMBINATION WYE & 1/8 BEND - ONE PIECE  
STYLE NO. P501  
ALL HUB**



Diameter	Item No.	Master Qty	Skid Qty	List
1 1/2	05853	50	900	166.45
2	05858	20	560	207.75
3	05852	10	180	457.25
4	05860	10	120	900.90

**COMBINATION WYE & 1/8 BEND,  
REDUCING - ONE PIECE  
STYLE NO. P502  
ALL HUB**



Diameter	Item No.	Master Qty	Skid Qty	List
2 x 1 1/2 x 1 1/2	05835	5	720	329.25
2 x 2 x 1 1/2	05865	20	980	233.75
3 x 3 x 1 1/2	05837	15	420	416.90
3 x 3 x 2	05857	10	350	312.35
4 x 4 x 2	05863	5	175	470.50
4 x 4 x 3	05864	5	140	607.00

**COMBINATION WYE & 1/8 BEND - TWO PIECE  
STYLE NO. P503  
ALL HUB**



Diameter	Item No.	Master Qty	Skid Qty	List
6	05266	2	32	3,468.40
8	05273	1	8	5,233.95

**COMBINATION WYE & 1/8 BEND,  
REDUCING - TWO PIECE  
STYLE NO. P504  
ALL HUB**



Diameter	Item No.	Master Qty	Skid Qty	List
6 x 6 x 3	05271	5	60	3,119.55
6 x 6 x 4	05267	5	60	3,648.95
8 x 8 x 4	05272	1	16	3,163.45

**DOUBLE COMBINATION WYE  
& 1/8 BEND, ASSEMBLED  
STYLE NO. P507  
ALL HUB**



Diameter	Item No.	Master Qty	Skid Qty	List
2 x 1 1/2	06034	10	490	1,291.95
3	06032	10	120	2,359.60
3 x 2	06035	10	180	814.40
4	06033	5	60	1,334.35
4 x 2	06036	5	90	2,570.70
4 x 3	06037	5	80	2,177.05

**COMBO WYE & 1/8 BEND  
W / LEFT SIDE INLET  
STYLE NO. P515  
ALL HUB**



Diameter	Item No.	Master Qty	Skid Qty	List
3 x 3 x 3 x 2	06009	10	180	1,393.90

**COMBO WYE & 1/8 BEND  
W / RIGHT SIDE INLET  
STYLE NO. P516  
ALL HUB**



Diameter	Item No.	Master Qty	Skid Qty	List
3 x 3 x 3 x 2	06008	10	180	1,393.90

**WYE  
STYLE NO. P600  
ALL HUB**



Diameter	Item No.	Master Qty	Skid Qty	List
1 1/4	05816	35	1,715	187.45
1 1/2	05822	50	1,400	125.10
2	05823	25	875	123.20
3	05824	25	300	333.05
4	05825	5	140	603.90
6	06135	4	48	1,743.40
8	06139	1	16	3,073.75

**WYE, REDUCING  
STYLE NO. P601  
ALL HUB**



Diameter	Item No.	Master Qty	Skid Qty	List
2 x 1 1/2 x 1 1/2	05831	25	1,225	172.15
2 x 1 1/2 x 2	05832	10	800	266.55
2 x 2 x 1 1/2	05826	25	1,225	150.60
3 x 3 x 1 1/2	05827	15	525	222.65
3 x 3 x 2	05828	25	400	246.20
4 x 4 x 1 1/2	05833	5	175	770.05
4 x 4 x 2	05829	10	180	361.50
4 x 4 x 3	05830	10	160	490.25
6 x 6 x 3	06138	5	60	1,693.85
6 x 6 x 4	06137	5	60	1,407.75
8 x 8 x 4	06140	1	16	2,968.15
8 x 8 x 6	05834	1	16	3,060.55

## PVC DWV FITTINGS

### WYE, STREET STYLE NO. P602 SP x H x H



Diameter	Item No.	Master Qty	Skid Qty	List
1 1/2	06367	50	1,750	231.70
2	06368	30	840	222.25
3	06369	10	280	483.60
4	06370	10	120	990.15

### WYE, STREET, REDUCING STYLE NO. P603 SP x H x H



Diameter	Item No.	Master Qty	Skid Qty	List
3 x 3 x 1 1/2	06372	20	360	560.65
3 x 3 x 2	06373	30	480	380.20
4 x 4 x 2	06374	10	180	1,130.40
4 x 4 x 3	06375	10	160	1,053.30

### DOUBLE WYE STYLE NO. P611 ALL HUB



Diameter	Item No.	Master Qty	Skid Qty	List
1 1/2	05838	40	1,120	281.30
2	05839	20	560	333.85
3	05840	15	180	652.85
4	05841	5	80	1,406.80
6	05842	2	24	2,629.85

### DOUBLE WYE W/ SIDE INLET STYLE NO. P615 ALL HUB



Diameter	Item No.	Master Qty	Skid Qty	List
3 x 3 x 3 x 3 x 2	05849	10	160	4,008.65

### DOUBLE WYE, REDUCING STYLE NO. P612 ALL HUB



Diameter	Item No.	Master Qty	Skid Qty	List
2 x 2 x 1 1/2 x 1 1/2	05847	10	560	286.80
3 x 3 x 1 1/2 x 1 1/2	05843	10	350	597.70
3 x 3 x 2 x 2	05844	10	280	486.50
4 x 4 x 2 x 2	05845	5	175	794.05
4 x 4 x 3 x 3	05846	5	90	1,048.70
6 x 6 x 4 x 4	06142	1	16	3,679.65

### WYE W/ LEFT SIDE INLET STYLE NO. P625 ALL HUB



Diameter	Item No.	Master Qty	Skid Qty	List
3 x 3 x 3 x 2	06155	5	175	1,648.95
4 x 4 x 4 x 2	06157	5	90	2,133.60

### WYE W/ RIGHT SIDE INLET STYLE NO. P626 ALL HUB



Diameter	Item No.	Master Qty	Skid Qty	List
3 x 3 x 3 x 2	06156	5	175	1,648.95
4 x 4 x 4 x 2	06158	5	90	2,133.60

### RETURN BEND STYLE NO. P700 H x H



Diameter	Item No.	Master Qty	Skid Qty	List
1 1/2	06466	20	1,600	124.90
2	06467	35	630	237.00
3	06468	10	280	665.20
4	06469	5	140	1,208.05

### P-TRAP W/ SOLVENT WELD JOINT STYLE NO. P706X H x H



Diameter	Item No.	Master Qty	Skid Qty	List
1 1/2	05214	25	1,225	145.80
2	05222	20	560	177.70
3	05230	10	180	600.20
4	05231	4	72	1,445.20

### P-TRAP W/ SOLVENT WELD JOINT & CLEAN OUT STYLE NO. P707X H x H



Diameter	Item No.	Master Qty	Skid Qty	List
1 1/2	05223	10	1,120	223.15
2	05224	10	560	388.10

### P-TRAP W/ UNION STYLE NO. P708P H x H



Diameter	Item No.	Master Qty	Skid Qty	List
1 1/2	05215	25	875	173.80
2	05216	20	560	400.70

### P-TRAP LOW PROFILE STYLE NO. P710 H x H



Diameter	Item No.	Master Qty	Skid Qty	List
2	05225	20	560	210.55

### LA P-TRAP W/ UNION & 2 SIZE SJ WASHERS STYLE NO. P711P SJ x H (FURNISHED W/BOTH Diameter SJ WASHERS)



Diameter	Item No.	Master Qty	Skid Qty	List
1 1/4 x 1 1/2	05220	25	700	341.50
1 1/2	05220	25	700	341.50

### DRUM TRAP, W/ CLEANOUT STYLE NO. P720X H x H (W/PLUG)



Diameter	Item No.	Master Qty	Skid Qty	List
3 x 6 x 1 1/2	06100	15	420	571.75

### CLOSET FLANGE STYLE NO. P800 H (ONE PIECE WITH SLOTS)



Diameter	Item No.	Master Qty	Skid Qty	List
4 x 4	05902	25	700	231.05

### CLOSET FLANGE, W/ STOP STYLE NO. P800S (ONE PIECE WITH SLOTS)



Diameter	Item No.	Master Qty	Skid Qty	List
4 x 3	05903	25	700	246.20

### CLOSET FLANGE, KNOCK OUT STYLE NO. P800KO H (ONE PIECE WITH SLOTS & KNOCK OUT TEST CAP)

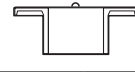

Diameter	Item No.	Master Qty	Skid Qty	List
4 x 3	05254	25	700	189.40
4 x 4	05253	25	700	339.35

### CLOSET FLANGE, SPIGOT, REDUCING STYLE NO. P801 SP (ONE PIECE PLASTIC)

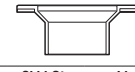

Diameter	Item No.	Master Qty	Skid Qty	List
4 x 3	05919	25	875	222.55

### CLOSET FLANGE - HUB, ADJUSTABLE METAL RING, EPOXY COATED STYLE NO. P811 H (W/ SLOTS)

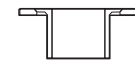

Diameter	Item No.	Master Qty	Skid Qty	List
4 x 3	05227	25	700	511.55
4 x 4	05226	25	700	530.90

### CLOSET FLANGE - SPIGOT, ADJUSTABLE METAL RING, EPOXY COATED STYLE NO. P812 EPOXY COATED SP

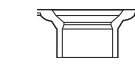

Diameter	Item No.	Master Qty	Skid Qty	List
4 x 3	05228	25	875	425.60
4 x 4	05229	25	700	596.65

### CLOSET FLANGE, SPIGOT, ADJUSTABLE, W/ PLASTIC RING STYLE NO. P812P SP

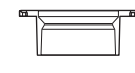

Diameter	Item No.	Master Qty	Skid Qty	List
4 x 3	05252	25	875	718.20
4 x 4	05264	25	700	840.90

### FLUSH CLOSET FLANGE STYLE NO. P815 H (FITS OVER 3" OR INSIDE 4" SCH 40 DWV PIPE)

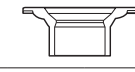

Diameter	Item No.	Master Qty	Skid Qty	List
4 x 4 / 4 x 3	05255	25	875	298.25

### FLUSH CLOSET FLANGE, KNOCK OUT STYLE NO. P815KO H (FITS OVER 3" OR INSIDE 4" SCH 40 DWV PIPE)

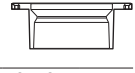

Diameter	Item No.	Master Qty	Skid Qty	List
4 x 4 / 4 x 3	05257	25	875	302.85

### OFFSET CLOSET FLANGE - HUB, EPOXY COATED ADJUSTABLE METAL RING STYLE NO. P820 H

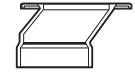

Diameter	Item No.	Master Qty	Skid Qty	List
4 x 3	05920	15	525	609.55